



Upper McKinley Playground Community Meeting

November 17, 2022

Meeting Overview

- Introductions
- Meeting Norms
- How a Playground is Designed
- Considerations for Upper McKinley
- New and Improved Design
 - Inclusive equipment
- Options
- Your Role
- Q&A



Introductions

Jake Wheatley,
Chief of Staff to Mayor Gainey

Chris Hornstein,
Director, Department of Public Works

Chrisarah Johnson,
Community Liaison, Mayor's Office of Neighborhood
Services



Meeting Norms

- Show each other respect
- Save questions for end of presentation
- Respect each other's time and share the conversation space with everyone



How a Playground is Designed

- Replacement vs. Redevelopment
 - Replacement
 - Footprint remains the same
 - Equipment is replaced in-kind
 - Generally shorter design/build times, less capital funding
 - Redevelopment
 - Expands/extends footprint beyond what already exists
 - More complex, typically longer timeline, more capital dollars



Considerations for Upper McKinley

- Playground is out of compliance with:
 - Current code
 - Guidelines
 - Standards for playground safety
- Equipment needs to be replaced ASAP for safety
- Small park in need of accessible equipment

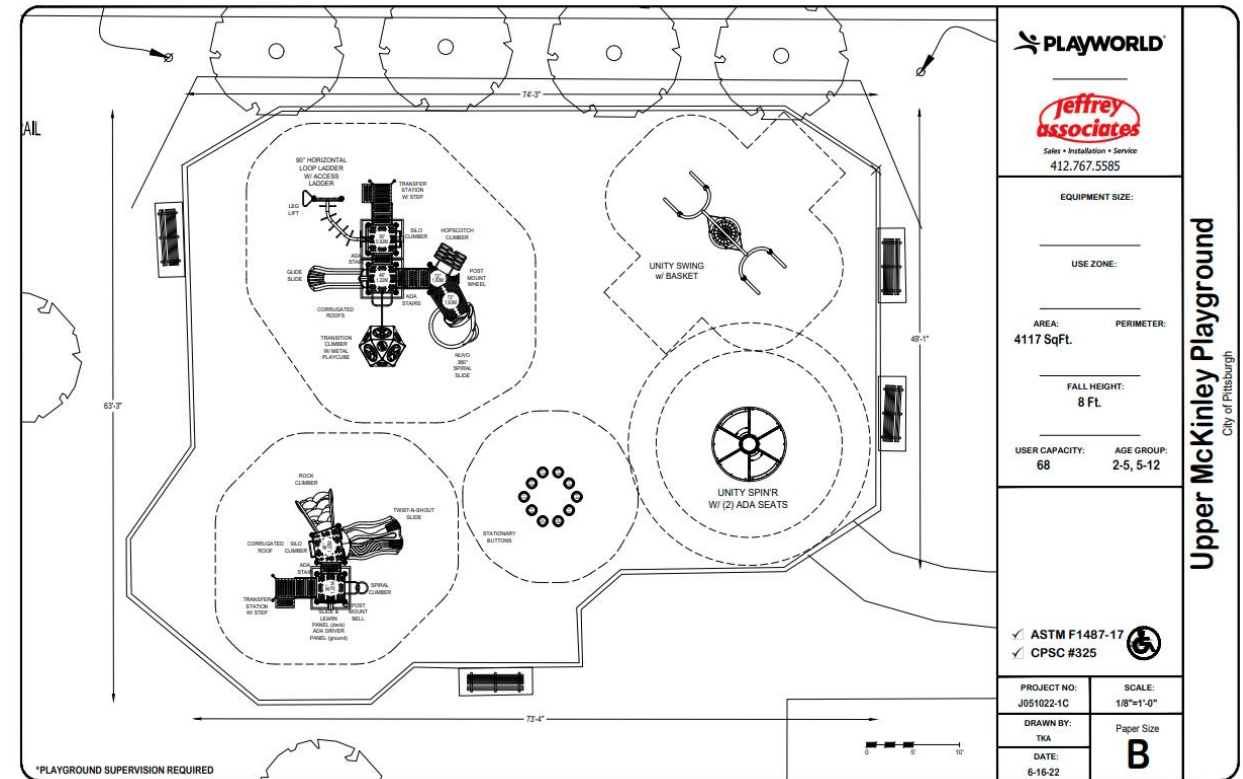

New and Improved Design

- All items being added/replaced are to meet inclusivity standards
- Design elements specially for individuals with mobility needs in mind
- Removal of 2-bay swing set for nest swing and unity spinner
 - Accommodates more kids at once



Rendering is for general purposes only---no trees will be removed



New and Improved Design: Nest Swing

- Meant to accommodate multiple children
 - All ages, sizes, and physical abilities
 - Encourages group play
- 1 nest swing can hold up to 6 kids

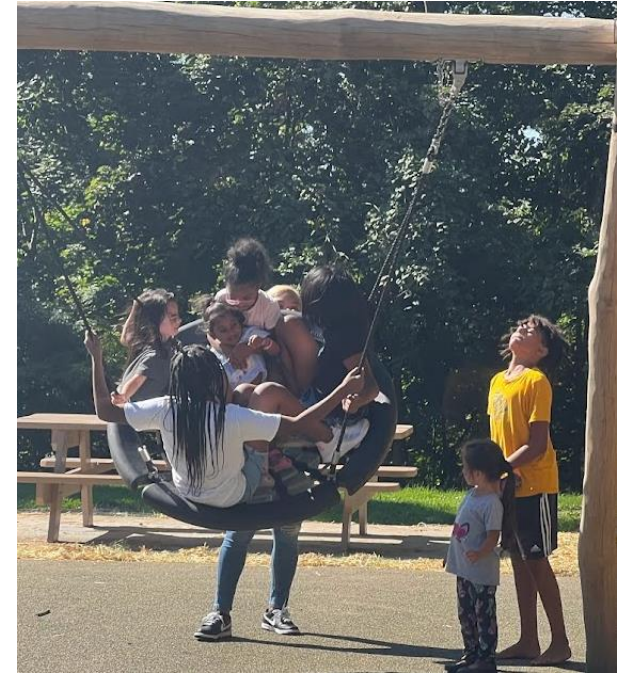

New and Improved Design: Unity Spinner

- Slow-moving, ADA-accessible piece of equipment
 - Includes children of all ages and abilities
 - Designated space for disabled individuals, with straps to safely secure
- **Not** a fast-moving or dangerous apparatus
 - Not like the merry-go-rounds of the 90's
- Can easily accommodate 10+ kids



Community decision

- **Option #1:** No installation in the spring
 - Design and install will take at least two years since it is not in the 2023 budget
 - New park would likely look similar to proposed design
- **Option #2:** Install in spring
 - The park, as shown in the previous images, is paid for and ready to go





Thank You!

Questions?

Contact neighbor@pittsburghpa.gov