

Four Mile Run Playground Renovation

Community Meeting #1

April 7, 2022



- I. Introduction
- II. Existing Conditions and Historic Context
 - I. Character Images
 - I. Big Ideas
 - I. Next Steps

Welcome & Introductions

- Funding: The City of Pittsburgh received a grant from Carnegie Mellon University for this work
 - Scope of Work
 - Playground
 - Safety Surface
 - Minor site improvements such as benches, trees / plantings as needed and if budget allows
- Who is involved?
 - Council District 5
 - Department of Public Works
 - Community Partners

- I. Introduction
- II. Existing Conditions and Historic Context
 - I. Character Images
 - I. Big Ideas
 - I. Next Steps

Existing Conditions

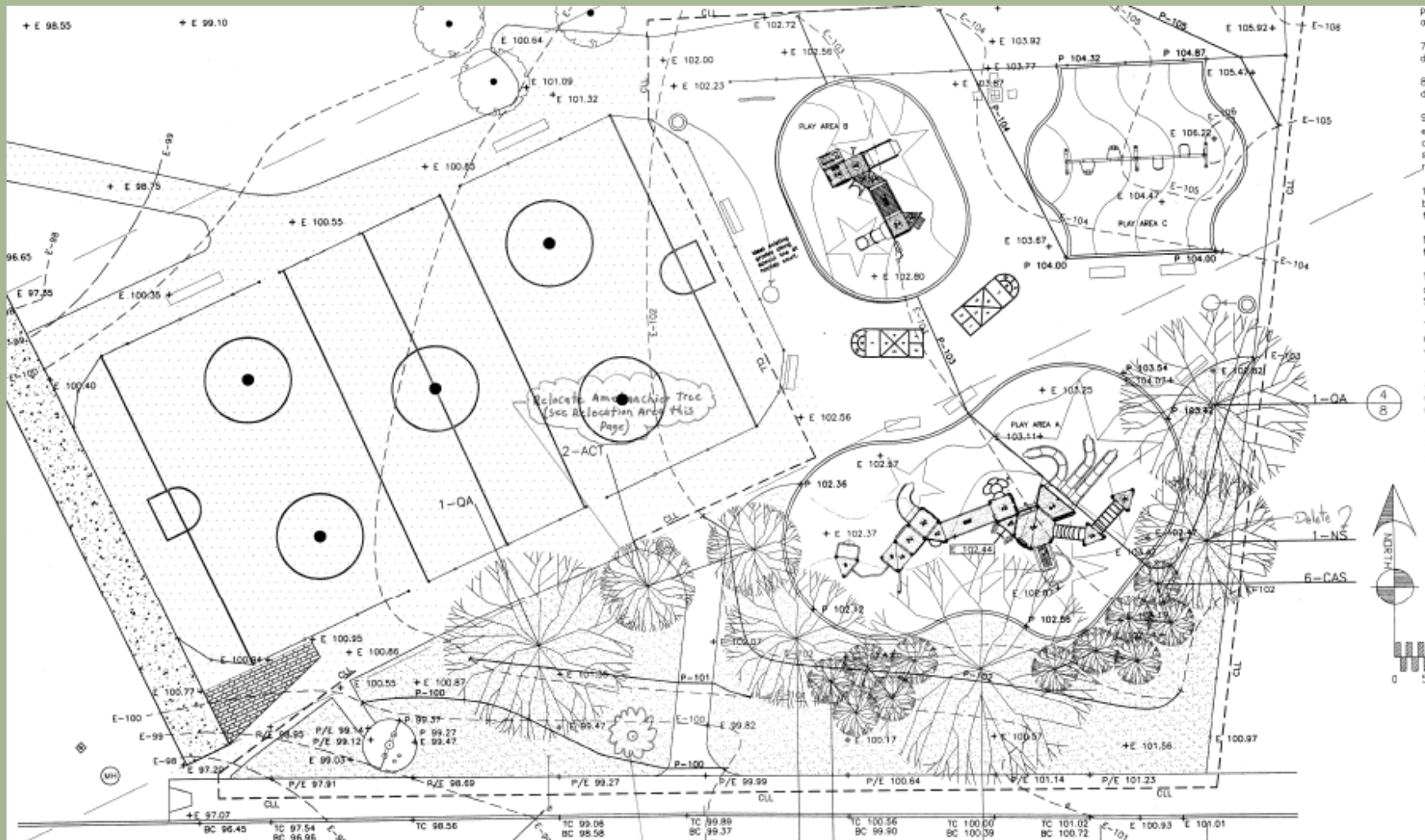

2003 Site Plan

- I. Introduction
- II. Existing Conditions and Historic Context
 - I. Character Images
 - I. Big Ideas
 - I. Next Steps

Existing Conditions



- I. Introduction
- II. Existing Conditions and Historic Context
 - I. Character Images
 - I. Big Ideas
 - I. Next Steps

Existing Conditions



- I. Introduction
- II. Existing Conditions and Historic Context**
 - I. Character Images
 - I. Big Ideas
 - I. Next Steps

Work-to-Date



- Last full renovation 2003
- Short-term repairs to equipment in 2021
- Site survey completed →

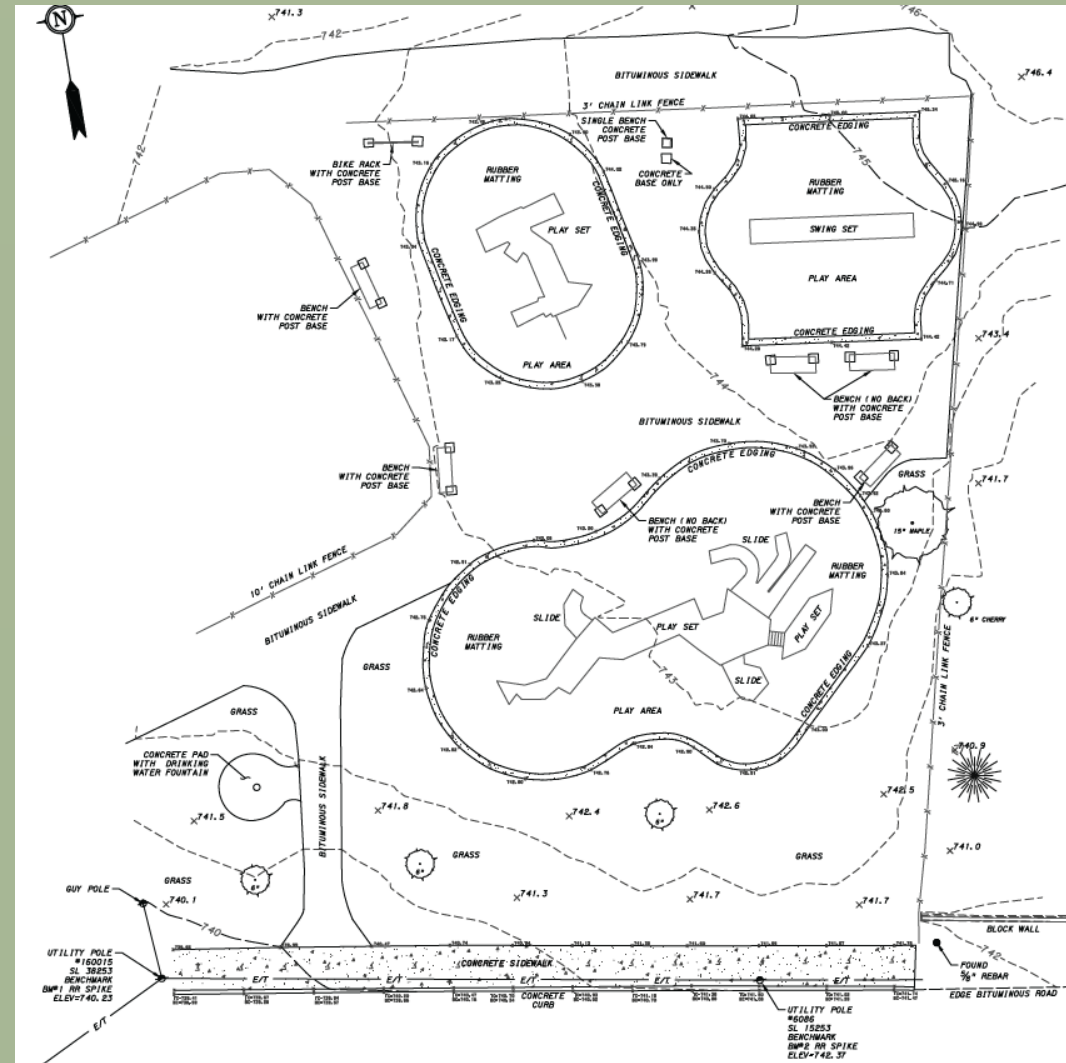

- I. Introduction
- II. Existing Conditions and Historic Context**
 - I. Character Images
 - I. Big Ideas
 - I. Next Steps

Character Images: Classic Playgrounds



- I. Introduction
- II. Existing Conditions and Historic Context
 - I. Character Images
 - I. Big Ideas
 - I. Next Steps

Character Images: Rope-Climber Playgrounds



- I. Introduction
- II. Existing Conditions and Historic Context
- I. **Character Images**
- I. Big Ideas
- I. Next Steps

Character Images: Geometric Playgrounds



- I. Introduction
- II. Existing Conditions and Historic Context
- I. Character Images
 - I. Big Ideas
 - I. Next Steps

Character Images: Nature Inspired Playgrounds



- I. Introduction
- II. Existing Conditions and Historic Context
- I. **Character Images**
- I. Big Ideas
- I. Next Steps

Big Ideas

- What do you like about the existing playground that you would like to see in the new playground?
- What general style of play equipment would you like to see used in the new playground?
- Is there anything else that you would like to see included in the new playground?

- I. Introduction
- II. Existing Conditions and Historic Context
 - I. Character Images
 - I. Big Ideas**
 - I. Next Steps

EngagePGH Survey Questions

- **Please take the survey at engage.pittsburghpa.gov/FourMileRunPG**
- Questions will include:
 - What neighborhood do you live in?
 - What is your relationship to the playground?
 - If you are a parent or caregiver, what ages of children are in your care?
 - How did you hear about the survey?
 - Are you affiliated with any relevant community groups?
 - Approximately how often do you visit the playground?
 - How do you usually get to the playground?
 - What parts of the existing playground would you like to see remain?
 - What parts of the existing playground would you like to see changed?
 - What style of equipment do you think is most appropriate here?

- I. Introduction
- II. Existing Conditions and Historic Context
 - I. Character Images
 - I. Big Ideas
 - I. **Next Steps**

Next Steps

- Next steps:
 - Community Engagement Survey
 - Community Meeting #2 – TBD
 - Present Concepts based on community feedback
- Questions? Contact: andrea.ketzel@pittsburghpa.gov
- Follow Updates: <https://engage.pittsburghpa.gov/fourmilerunPG>

- I. Introduction
- II. Existing Conditions and Historic Context
 - I. Character Images
 - I. Big Ideas
 - I. **Next Steps**