

### 3. CONCEPT DESIGN

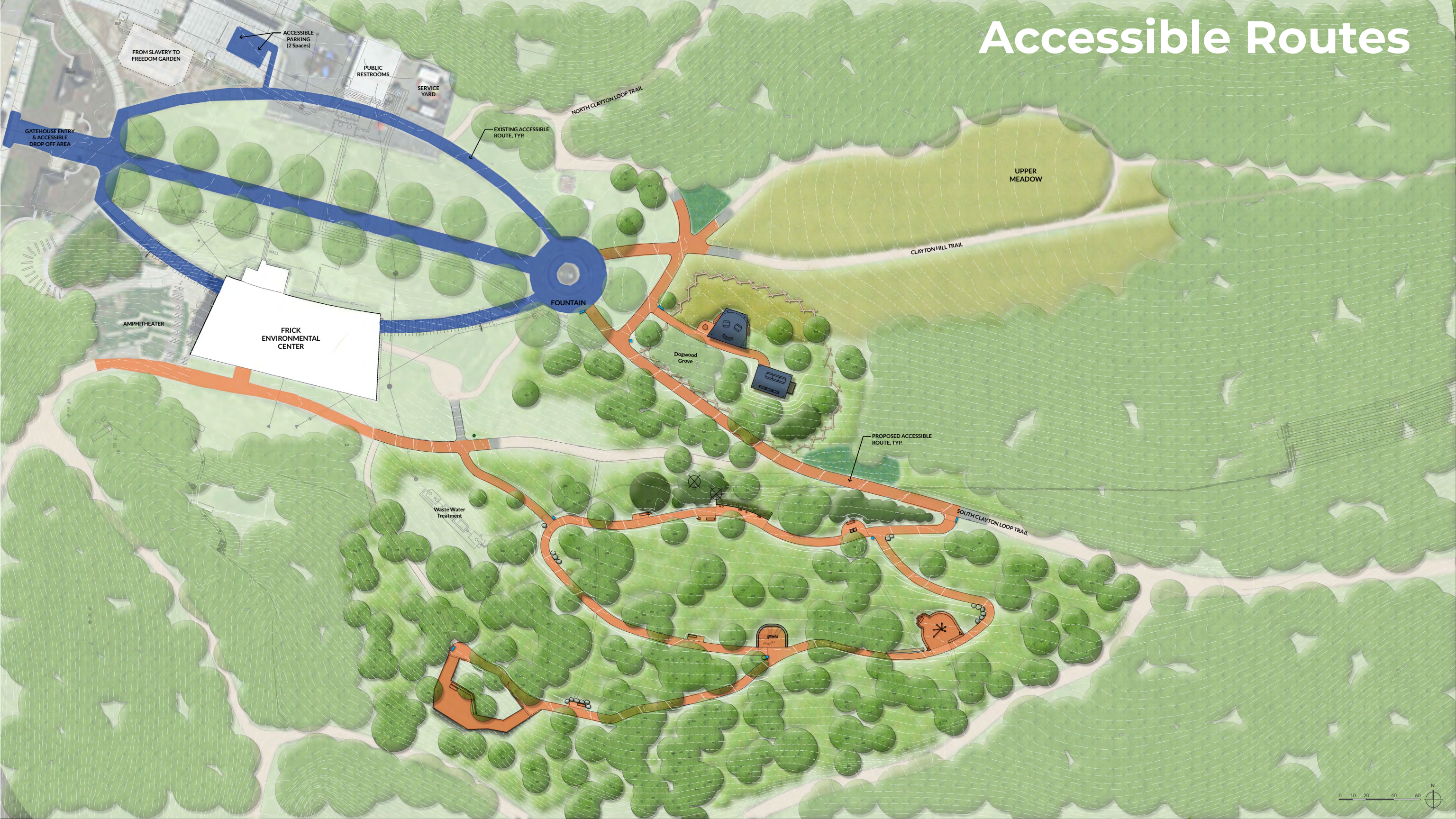



# Accessible Routes





# Nature Discovery Space

UPPER  
MEADOW

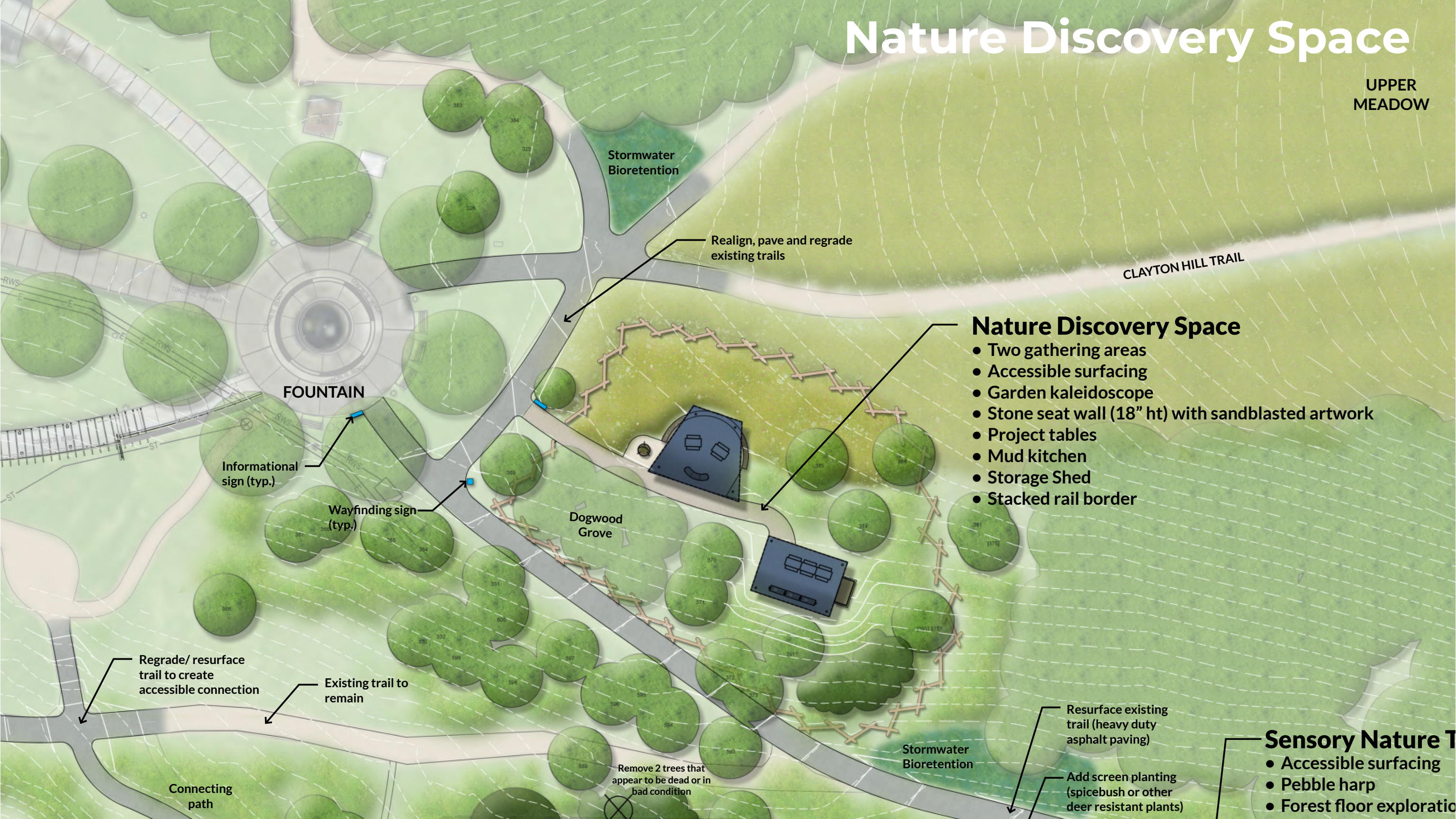

Stormwater  
Bioretention

Realign, pave and regrade  
existing trails

CLAYTON HILL TRAIL

FOUNTAIN

Informational  
sign (typ.)

Wayfinding sign  
(typ.)

Dogwood  
Grove

## Nature Discovery Space

- Two gathering areas
- Accessible surfacing
- Garden kaleidoscope
- Stone seat wall (18" ht) with sandblasted artwork
- Project tables
- Mud kitchen
- Storage Shed
- Stacked rail border

Regrade/ resurface  
trail to create  
accessible connection

Existing trail to  
remain

Connecting  
path

Remove 2 trees that  
appear to be dead or in  
bad condition

Stormwater  
Bioretention

Resurface existing  
trail (heavy duty  
asphalt paving)

Add screen planting  
(spicebush or other  
deer resistant plants)

## Sensory Nature T

- Accessible surfacing
- Pebble harp
- Forest floor exploration



# Nature Discovery Space: Structures and Surfacing



Stone Seat Wall



Stone Seat Wall - Sandblasted Artwork

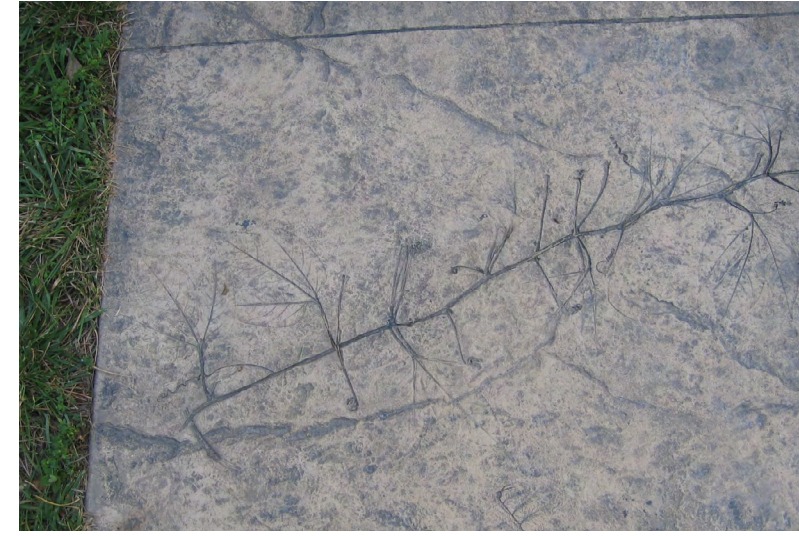

Tinted concrete paving with leaf imprints



Shade structures



Garden Kaleidoscope

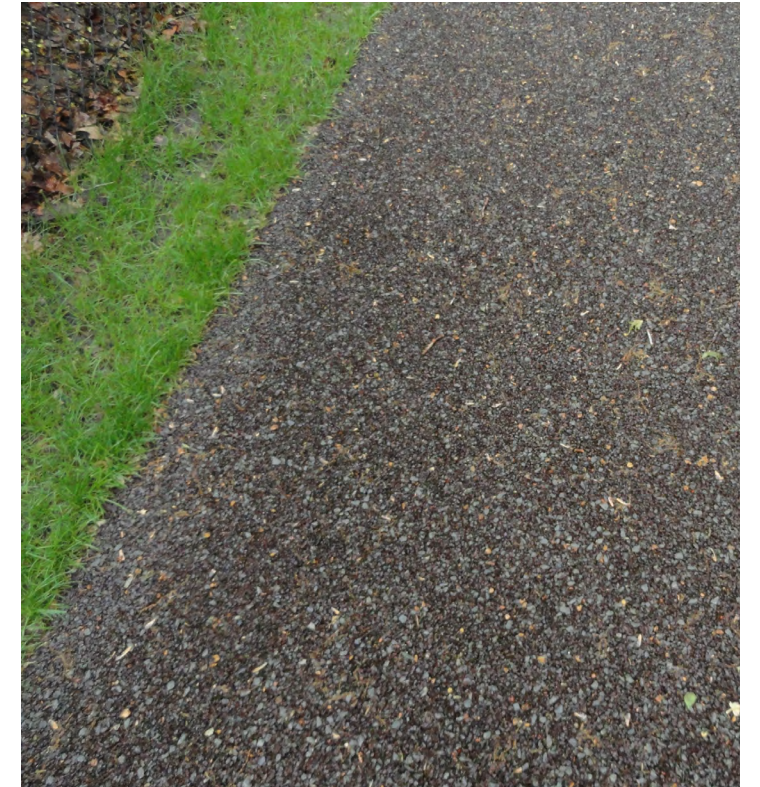

Flexipave path



# Nature Discovery Space: Furnishings



Custom wheelchair accessible project table



Moveable project table with benches (22" ht.)



Custom roll-under counter with mixing basin  
(can be set at any height, fixed in place)



Possible alternative - Mud kitchen (not roll under, not customizable)



# Nature Discovery Space: Border, Storage, Activities



Edging: Stacked rail



Loose Parts for Nature Projects



Fort Building



Nature Art Projects



Shed