

Block by Block Recommendations | Negley Ave to Beatty St

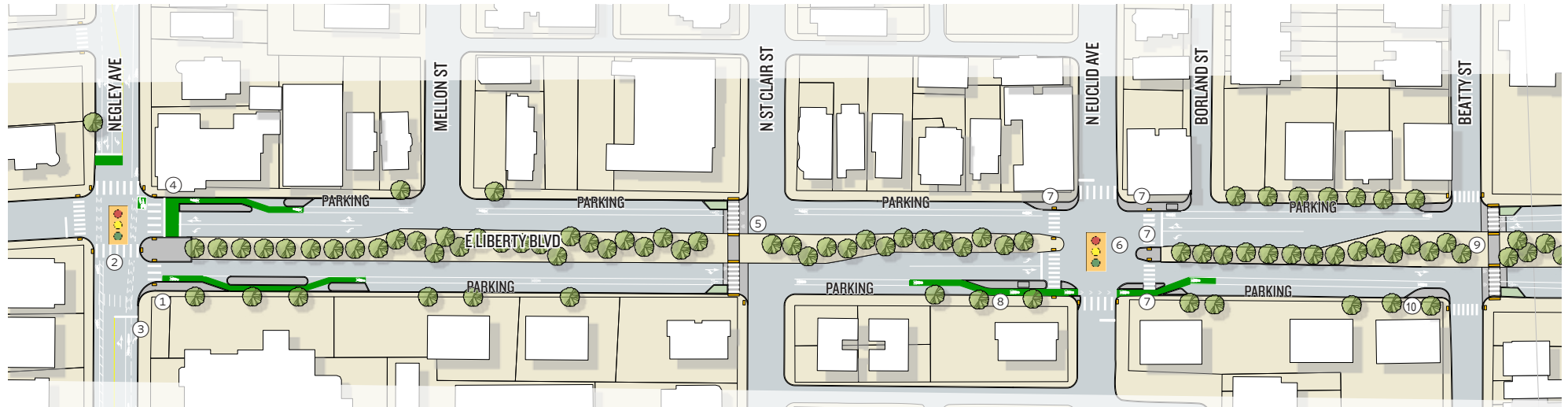

Intersection	Existing Safety Issues	Safety Recommendations (Reference #)
E Liberty & Negley	<ul style="list-style-type: none"> 1 vehicular and 2 pedestrian crashes Poor pedestrian crossing Needs new traffic and pedestrian signals Bus stop conflicts with bike lane 	<ol style="list-style-type: none"> 1. Provide curb bumpouts 2. Upgrade signals 3. Add pavement marking to clarify bike lane and right turn lane function 4. Reroute bike lane behind bus stop
E Liberty & Mellon	<ul style="list-style-type: none"> No vehicular or pedestrian crashes 	No proposed improvements
E Liberty & St Clair	<ul style="list-style-type: none"> No vehicular or pedestrian crashes 	<ol style="list-style-type: none"> 5. Provide Hi Viz raised crosswalks with ramps and paths to meet ADA accessibility requirements.
E Liberty & Euclid	<ul style="list-style-type: none"> 2 vehicular crashes with no pedestrian incident No pedestrian signals. Crosswalk bypasses pedestrian refuge Bus stop and bike lane conflicts 	<ol style="list-style-type: none"> 6. Upgrade signals 7. Provide curb bumpouts and extend median for pedestrian safety 8. Reroute bike lane behind bus stop and place bus stop on bumpout
E Liberty & Borland	<ul style="list-style-type: none"> No vehicular or pedestrian crashes 	No proposed improvements
E Liberty & Beatty	<ul style="list-style-type: none"> No vehicular or pedestrian crashes Worn pedestrian path through median making an unsafe mid block crosswalk 	<ol style="list-style-type: none"> 9. Provide Hi Viz raised crosswalks with ramps and paths to meet ADA accessibility requirements 10. Provide curb bumpouts on E Liberty Boulevard.



Key	
	New Signal
	ADA Ramp
	Bus Shelter
	Bike Lane Barriers
	Bike Lane
	Crosswalk
	Street Tree

Crash data is from 2017-2021 collected from Pennsylvania Crash Information Tool (PCIT)

Block by Block Recommendations | Selma St to Centre Ave

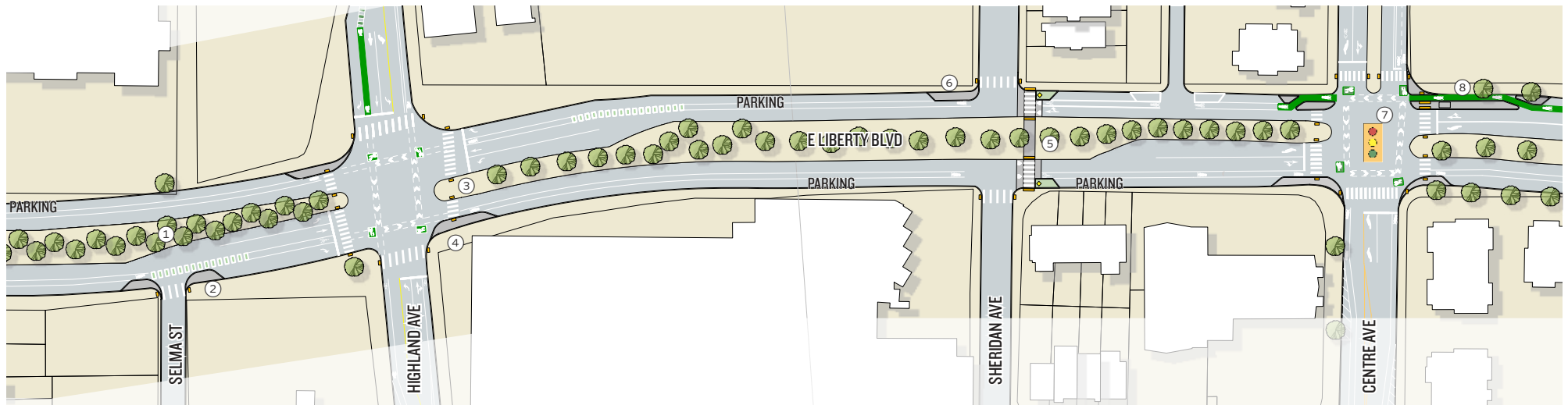

Intersection	Existing Safety Issues	Safety Recommendations (Reference #)
E Liberty & Selma	<ul style="list-style-type: none"> No vehicular or pedestrian crashes Worn pedestrian path through median Cars parking too close to intersection 	<ol style="list-style-type: none"> Provided landscaping to deter pedestrians from walking through median Provide curb bumpouts on East Liberty
E Liberty & Highland	<ul style="list-style-type: none"> 5 vehicular crashes with pedestrian incident Median grades too steep for ADA access 	<ol style="list-style-type: none"> Level median to accommodate ADA requirements Provide curb bumpouts. Place bus shelters on curb bumpouts
E Liberty & Sheridan	<ul style="list-style-type: none"> 1 vehicular and 1 pedestrian crash Worn pedestrian path through median Large radius on SW corner 	<ol style="list-style-type: none"> Provide Hi Viz raised crosswalks with ramps and paths to meet ADA accessibility requirements Provide curb bumpouts on E Liberty Boulevard
E Liberty & Centre	<ul style="list-style-type: none"> 12 vehicular crashes with no pedestrian incident No advanced left turn phases Bus stop and bike lane conflicts No pedestrian signals 	<ol style="list-style-type: none"> Upgrade signals Provide curb bumpouts. Route bike lanes behind bus stop. Place bus shelter on bumpout.

Key

- New Signal
- ADA Ramp
- Bus Shelter
- Bike Lane Barriers
- Bike Lane
- Crosswalk
- Street Tree

Crash data is from 2017-2021 collected from Pennsylvania Crash Information Tool (PCIT)

Block by Block Recommendations | Larimer Ave



Intersection	Existing Safety Issues	Safety Recommendations (Reference #)
E Liberty & Larimer	<ul style="list-style-type: none">• 9 vehicular and 1 pedestrian crashes• Poor pedestrian visibility around parked cars• Bike lane and bus stop conflicts	<ol style="list-style-type: none">1. Straighten crosswalks and upgrade curb ramps2. Provide curb bumpouts on East Liberty and route bike lanes behind bus stop3. Place bus shelters on curb bumpouts4. Upgrade signal

N

Key

New Signal

ADA Ramp

Bus Shelter

Bike Lane Barriers

Bike Lane

Crosswalk

Street Tree

Crash data is from 2017-2021 collected from Pennsylvania Crash Information Tool (PCIT)

Block by Block Recommendations | Broad St to Railroad/Busway Underpass



Intersection	Existing Safety Issues	Safety Recommendations (Reference #)
E Liberty & Broad	<ul style="list-style-type: none"> 9 vehicular and 2 pedestrian crashes Poor pedestrian visibility around parked cars Bike lane and bus stop conflicts 	2021 Upgrade. No changes proposed.
E Liberty & Hamilton	<ul style="list-style-type: none"> 2 vehicular crashes with pedestrian incident Missing “no Turn on Red” signs Needs more bike commendations for eastbound 	1. Add “No Turn on Red” signs at all approaches
Railroad/ Busway Underpass	<ul style="list-style-type: none"> No lighting under the Railroad and Busway underpass 	2. Provide lighting for the underpass

Key

- New Signal
- ADA Ramp
- Bus Shelter
- Bike Lane Barriers
- Bike Lane
- Crosswalk
- Street Tree

Crash data is from 2017-2021 collected from Pennsylvania Crash Information Tool (PCIT)

Block by Block Recommendations | Dahlem Pl to Penn Ave

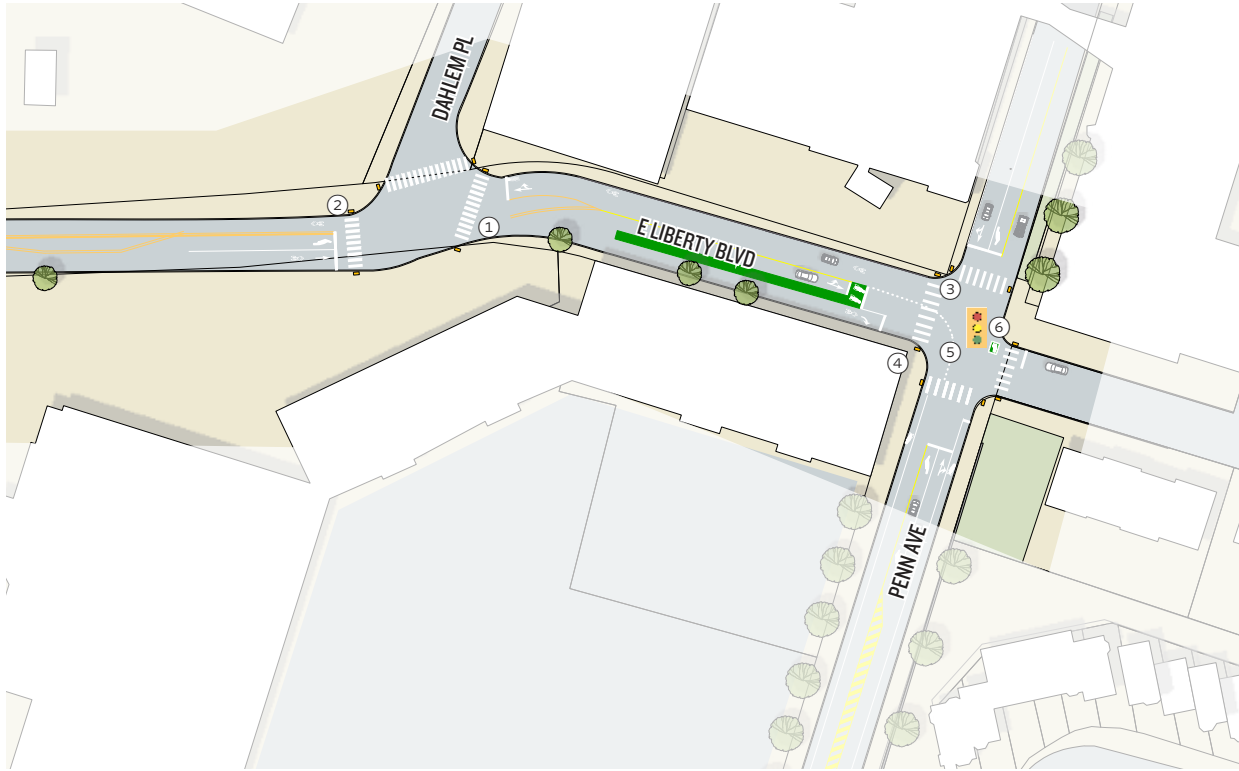

Intersection	Existing Safety Issues	Safety Recommendations (Reference #)
E Liberty & Dahlem	<ul style="list-style-type: none"> 2 vehicular and 1 pedestrian crashes Poor crosswalk conditions Overgrown vegetation 	<ol style="list-style-type: none"> 1. Install Hi Viz crosswalk 2. Trim vegetation
E Liberty & Penn	<ul style="list-style-type: none"> 20 vehicular and 1 pedestrian crashes Poor pedestrian visibility Signal is damaged Turning traffic cuts corner from Penn to E Liberty 	<ol style="list-style-type: none"> 3. Update ADA ramps and include audible pedestrian signals 4. Install No Turn on Red signs 5. Install dotted trace line for those turning from Penn to E Liberty 6. Upgrade signal
East Liberty Boulevard Corridor		Entire corridor recommended speed limit should be 25MPH by standards based on use. Proposing to change speed limit to 25MPH



Key	
	New Signal
	ADA Ramp
	Bus Shelter
	Bike Lane Barriers
	Bike Lane
	Crosswalk
	Street Tree

Crash data is from 2017-2021 collected from Pennsylvania Crash Information Tool (PCIT).