

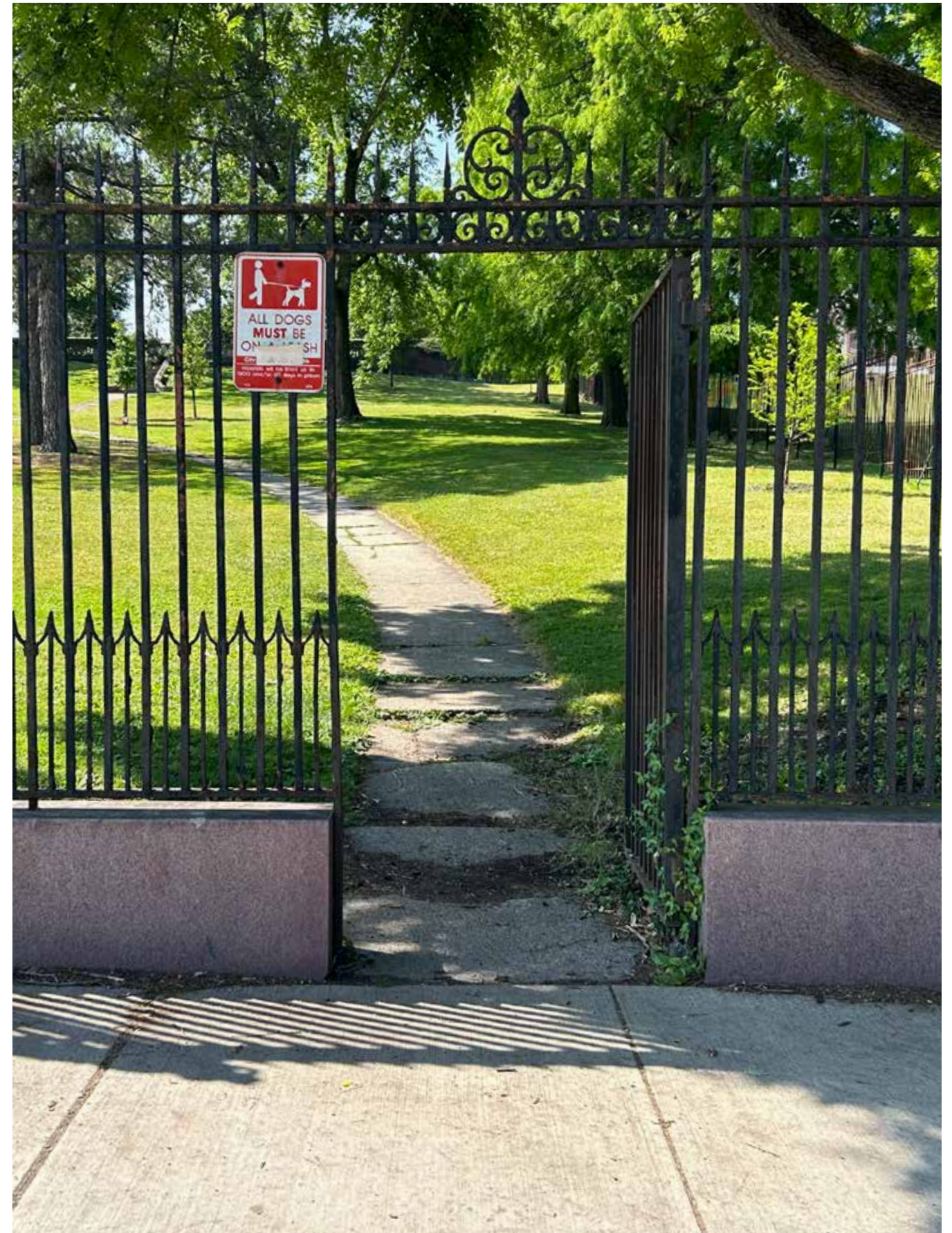

MELLON PARK

ENTRANCES AND SIGNAGE IMPROVEMENTS PROJECT | January 4, 2024

- 01 ACTION PLAN REVIEW
- 02 OVERVIEW OF SIGNAGE STANDARDS
- 03 PROPOSED ENTRANCE/SIGNAGE TREATMENTS
- 04 QUESTIONS AND DISCUSSION



ACTION PLAN PRIORITIES

*Goals advanced by this project are **bold**

- **Improve/provide safe pedestrian and bicycle access to both sides of the park.**
- **Provide more and better wayfinding and signage.**
- Provide more opportunities for parking without sacrificing usable park space.
- **More park amenities** (benches, tables, bike racks, etc.)
- Provide a diversity of events without over-programming the park.
- **Respect the history, trees, open space, and landscapes that characterize Mellon Park.**
- Resolve user conflicts with off-leash dogs.



MELLON PARK ENTRANCES AND SIGNAGE PROJECT | DEVELOPMENT ACTIVITIES MEETING | JANUARY 04, 2024

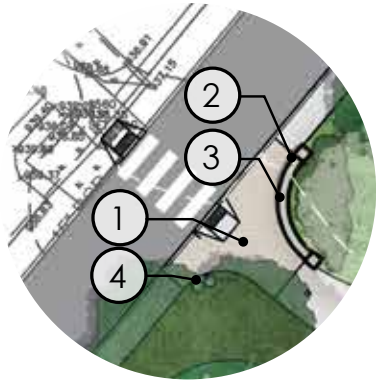

**BAKERY SQ. BLVD
& SALLY'S PATH**

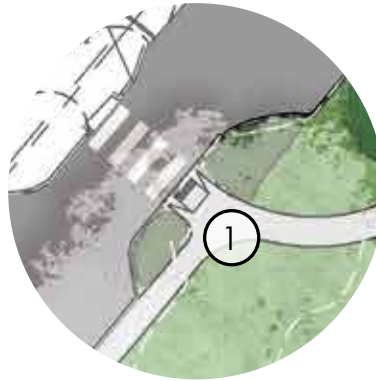

**BAKERY SQ. BLVD
& LIVING PLACE**

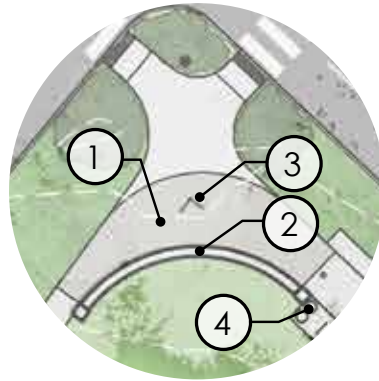

**BAKERY SQ. BLVD
& PENN AVE**

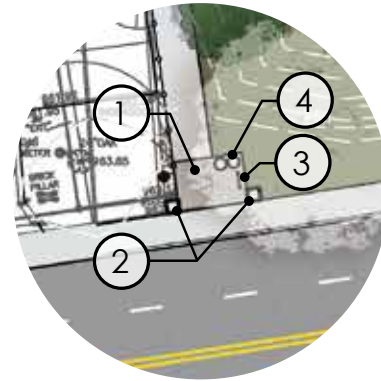

**FIFTH AVENUE @
TENNIS BUBBLE**

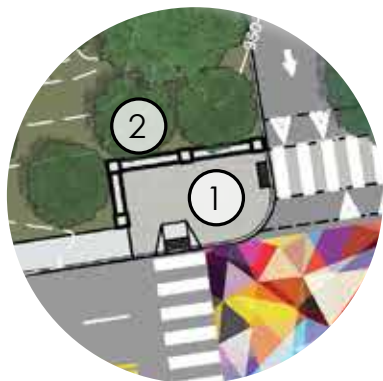

**FIFTH AVE &
BEECHWOOD BLVD**

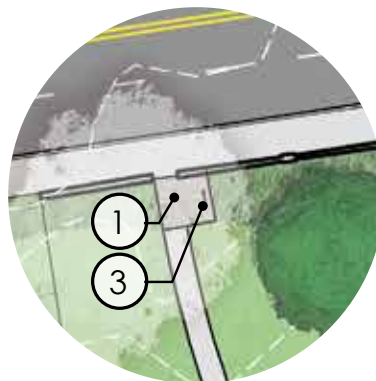

**FIFTH AVE
(WEST ENTRANCE)**

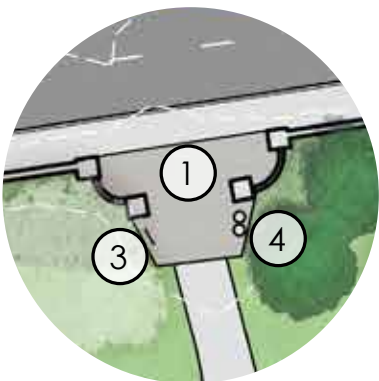

**FIFTH AVE
(WEST ENTRANCE)**

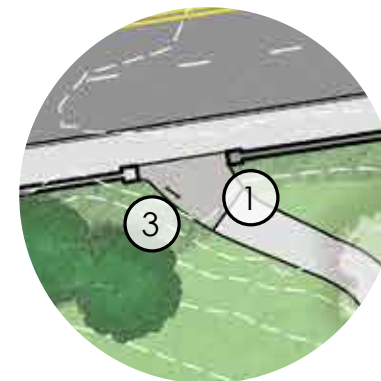

**FIFTH AVE
(WEST ENTRANCE)**

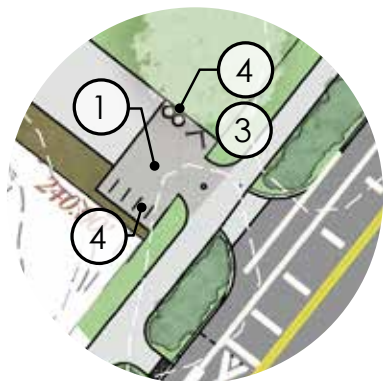

**BEECHWOOD BLVD
(WEST ENTRANCE)**

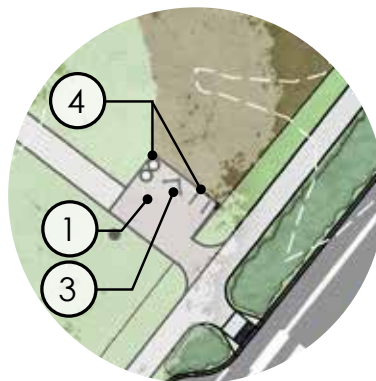

**BEECHWOOD BLVD
(EAST ENTRANCE)**

PROJECT GOALS

- Establish consistent design language and materials suitable for use on both sides of the park.
- Develop a signage package that provides opportunities for park identification, wayfinding, and clearly articulates park rules and regulations.
- Design welcoming entrances and provide consistent entrance experiences on both sides of the park.
- Provide park amenities and site furnishings where appropriate.
- Provide a diversity of events without over-programming the park.

SCOPE

- ① New entry plazas with specialty paving at existing entrances.
- ② Seat walls, piers, or other form of gateway where appropriate.
- ③ Park identification, wayfinding, and interpretive signage where appropriate.
- ④ Benches, trash receptacles, bike racks, and other site furnishings where appropriate.
 - Ancillary site work.

OVERVIEW OF SIGNAGE STANDARDS

ALL SIGNAGE DESIGNS SHOWN HERE ADHERE TO THE 2016 OPEN SPACE SIGNAGE STANDARDS

SIGNAGE TYPES MAY BE POST, FENCE, OR WALL MOUNTED

SIGNAGE TYPE MAY BE
FENCE OR WALL MOUNTED



ENTRY (TALL)
24" x 36"



ENTRY (HORIZONTAL)
40" x 60"



ENTRY (NO AMENITIES)
24" x 20"
*[Based on standard for
Greenway Entry Without Map]*



BOUNDARY SIGN (VEHICULAR)
60" x 8"
[Custom alternative is shown in concepts herein]



BOUNDARY (PEDESTRIAN)
16" x 8"
*[Not currently shown in
concepts]*

STANDARDS PULLED FROM THE 2016 OPEN SPACE SIGNAGE STANDARDS

POST-MOUNTED DETAILS

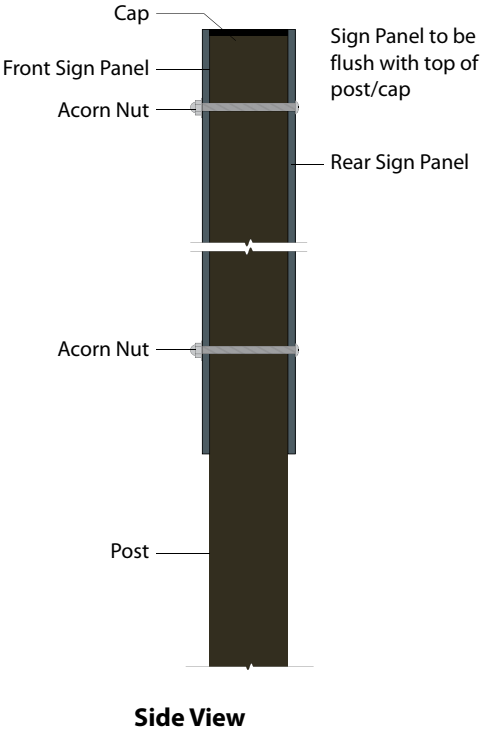
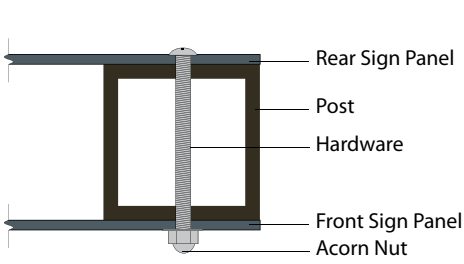
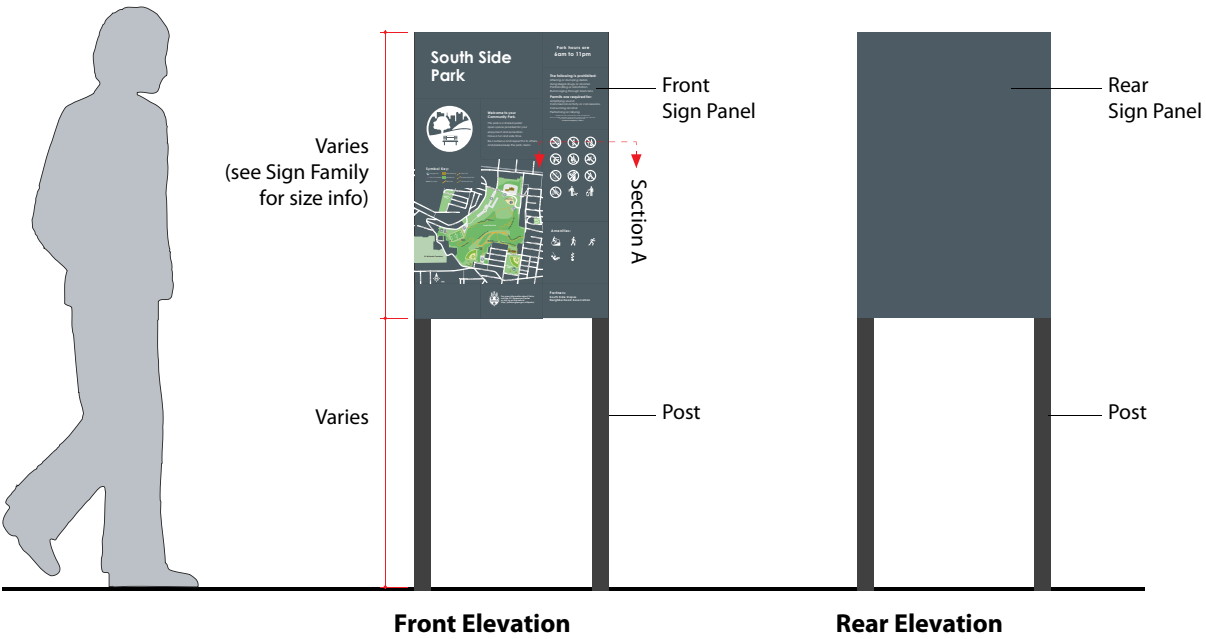

Sign Panel

- 0.080 inch ASTM B 209 (ASTM B 209M) aluminum sheet/ plate OR 3mm Dibond PE aluminum composite material (ACM)
- For single sided Dibond signs, black back is to show
- Apply vinyl to face as required.
 - "Scotchcal" 3M non-reflective opaque vinyl film, or approved equivalent
 - Apply graffiti-proof laminate
 - Thickness shall be 0.003 inch minimum and 0.006 inch maximum, or as specified.
 - The pigmented material shall be sufficiently opaque when applied to completely hide a contrasting white printed text on a blue surface.
 - Properly processed and applied material shall withstand 5 years vertical, south facing, unprotected, exterior exposure at the work site with no appreciable deterioration such as cracking, checking, blistering, delamination, or loss of adhesion. The material will show no appreciable discoloration after cleaning.
 - Shrinkage shall not exceed 1/64 inch (0.4mm) in any direction.
 - Screen inks shall be "Scotchcal" brand opaque screen printing inks Series 3900, or approved equivalent.
 - Press ink shall be "Scotchcal" brand letterpress inks Series 850, or approved equivalent.

Hardware

- See hardware details page
- Screw placement - as shown on artwork

Foundation

- See foundation details page.

Installation

- See drawing(s)
- Attach sign panel(s) to posts before instillation in ground. This may be done with hardware or temporarily. Sign panel shall be flush with post edge.
- Install signs level, plumb, and at the height indicated, with sign surfaces free from distortion or other defects in appearance.

Black Cap

- Plastic or aluminum cap to be placed in end of post if under 6' tall



FENCE-MOUNTED SECTION

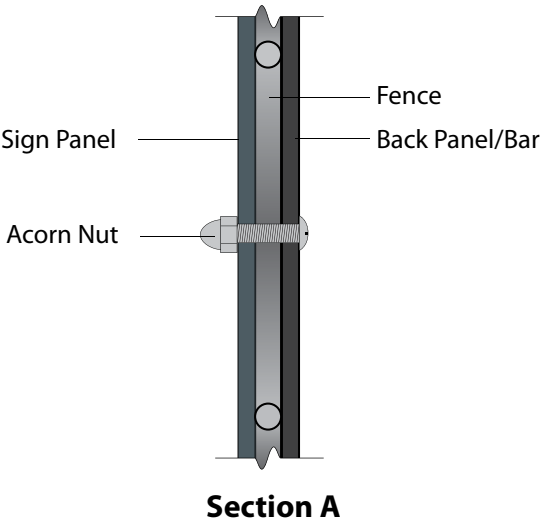



Welcome to your Community Park.

This park is a shared public open space provided for your enjoyment and recreation. Have a fun and safe time. Be courteous and respectful to others, and please keep the park clean.

Mellon Park

Park hours are 6AM - 11PM

The following is prohibited:
Littering or dumping debris
Using illegal drugs or alcohol
Panhandling or solicitation
Rummaging through trash receptacles

Permits are required for:
Amplifying sound
Commercial activity or concessions
Consuming alcohol
Performing or rallying

The following is prohibited:
Littering or dumping debris
Using illegal drugs or alcohol
Panhandling or solicitation
Rummaging through trash bins

Permits are required for:
Amplifying sound
Commercial activity or concessions
Consuming alcohol
Performing or rallying

Chapter 473, 475, 477 & 633 City Code of Ordinances
Fines up to \$300. All Federal, Pennsylvania, and City laws are enforced.
The park is patrolled by Pittsburgh Police.
To report an emergency, call 911

Welcome to your Community Park.

This park is a shared public open space provided for your enjoyment and recreation. Have a fun and safe time. Be courteous and respectful to others, and please keep the park clean.

Symbol Key:

- Playground
- City Steps
- Trail
- Lawn
- Woodland
- Park Building
- Point of Interest



City of Pittsburgh
For more information about Parks, call the 311 Response Center

Pittsburgh Parks Conservancy







Cobblestone



Sandstone



Brick



Exposed Aggregate
Concrete



Granite

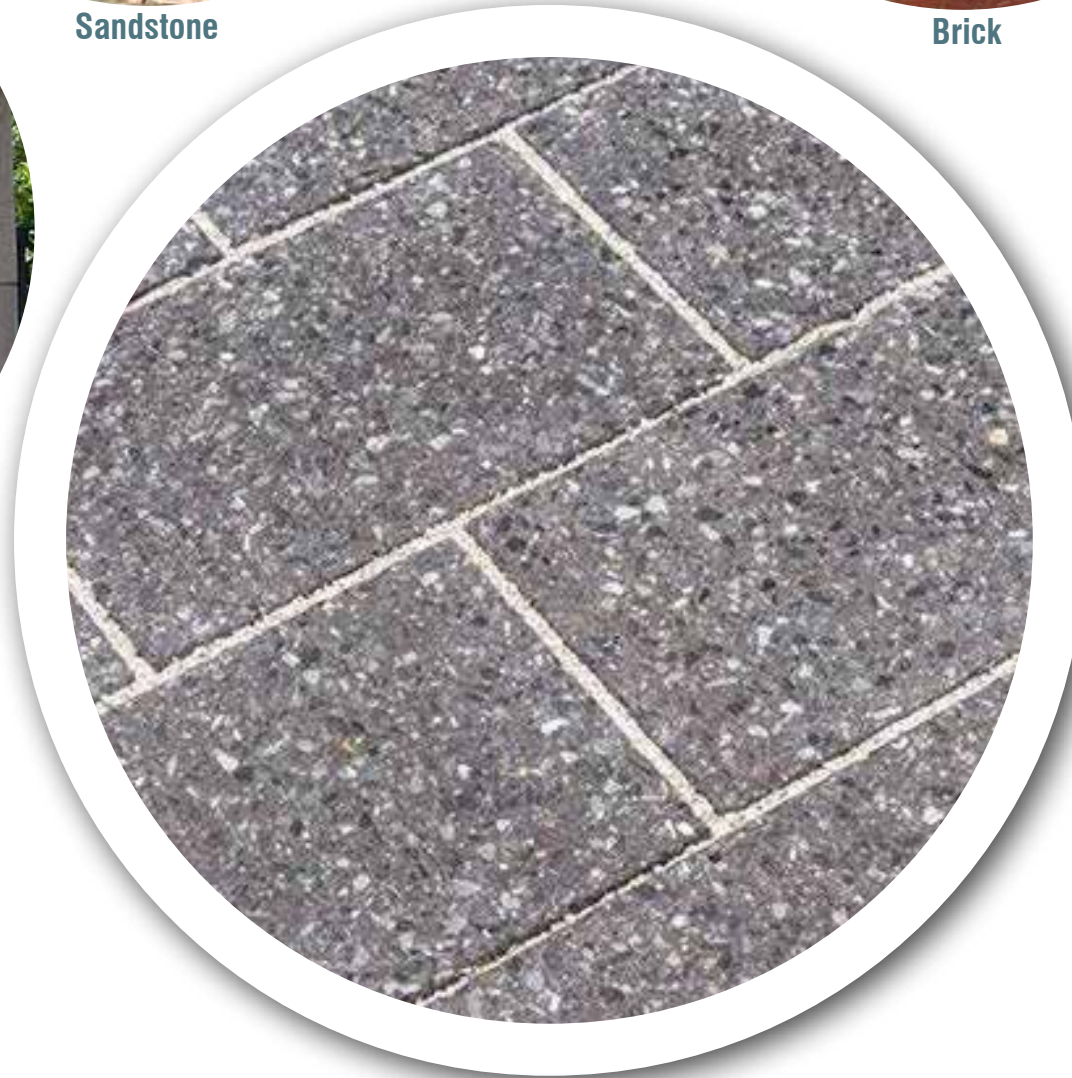

Asphalt



Concrete



Colored Concrete



BENCH OPTION

Product Information

Model: City of Pittsburgh
Park Bench (6'-0")

Manufacturer:
Architectural Iron
Company

Color/Finish:
White Oak w. ACE Spar
Varnish; High Performance
Enamel, Gloss Black (poly-
urethane epoxy)



LITTER RECEPTACLE

Product Information

Model: SD-42

Manufacturer:
Victor Stanley

Color/Finish:
Powder-coat,
Black



BIKE RACK

Product Information

Model: Hoop Rack
Heavy Duty

Manufacturer:
Dero

Color/Finish:
Stainless Steel

KEY

SIGNAGE SOLUTIONS

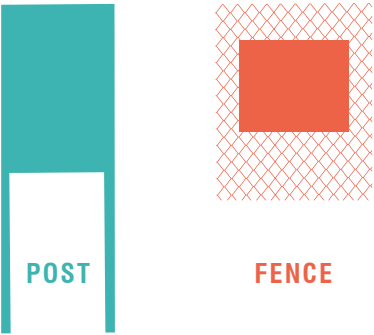

SITE FURNITURE

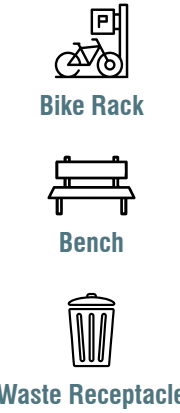

SIGNAGE & SITE FURNITURE DIAGRAM

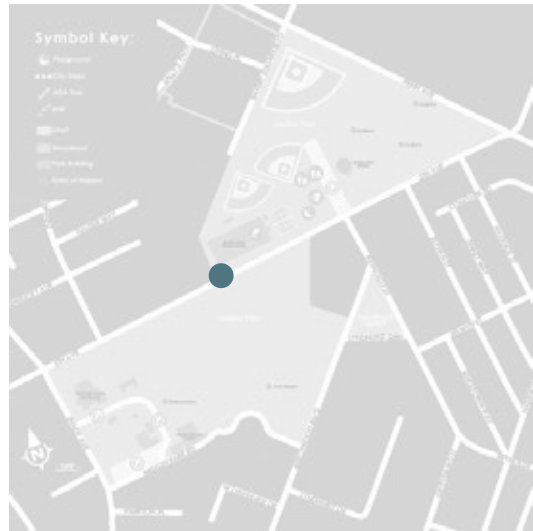

PERSPECTIVE ILLUSTRATION

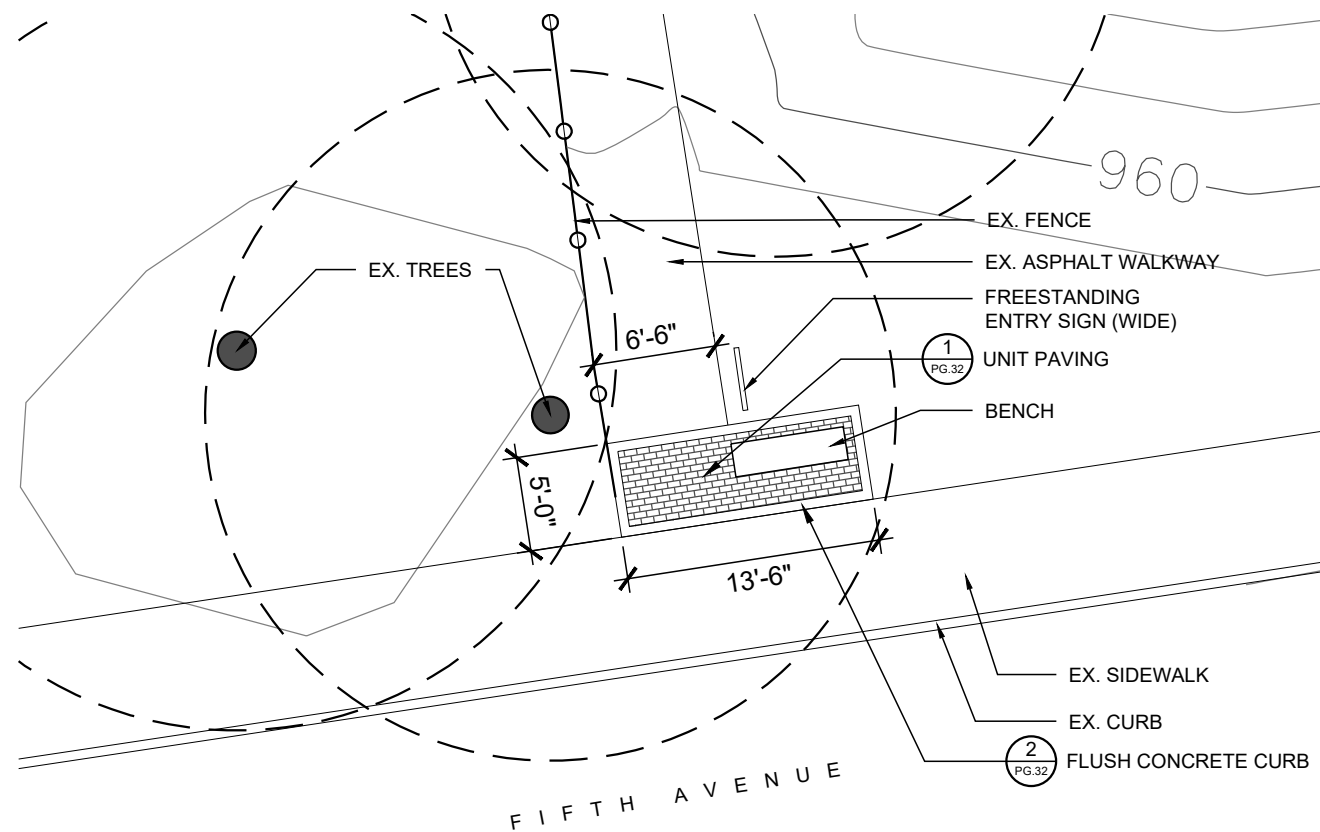

SITE PLAN*

Scale: 1"=10'

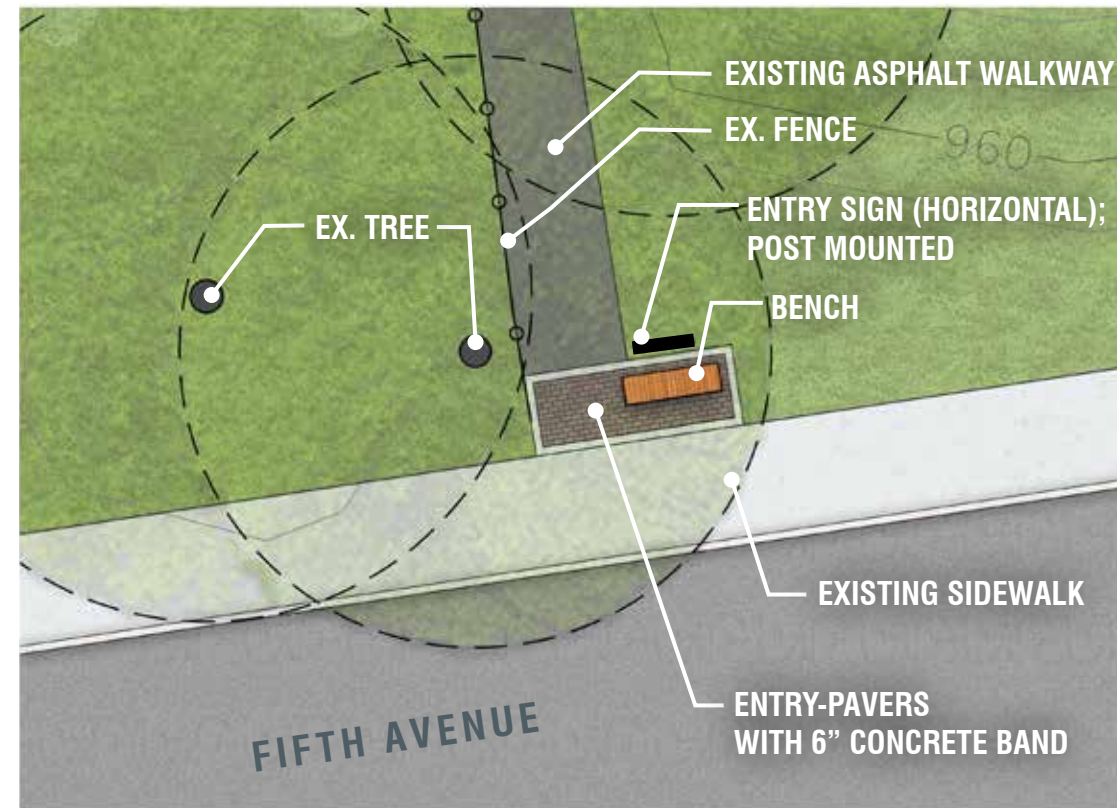

SITE PLAN

Scale: N.T.S.

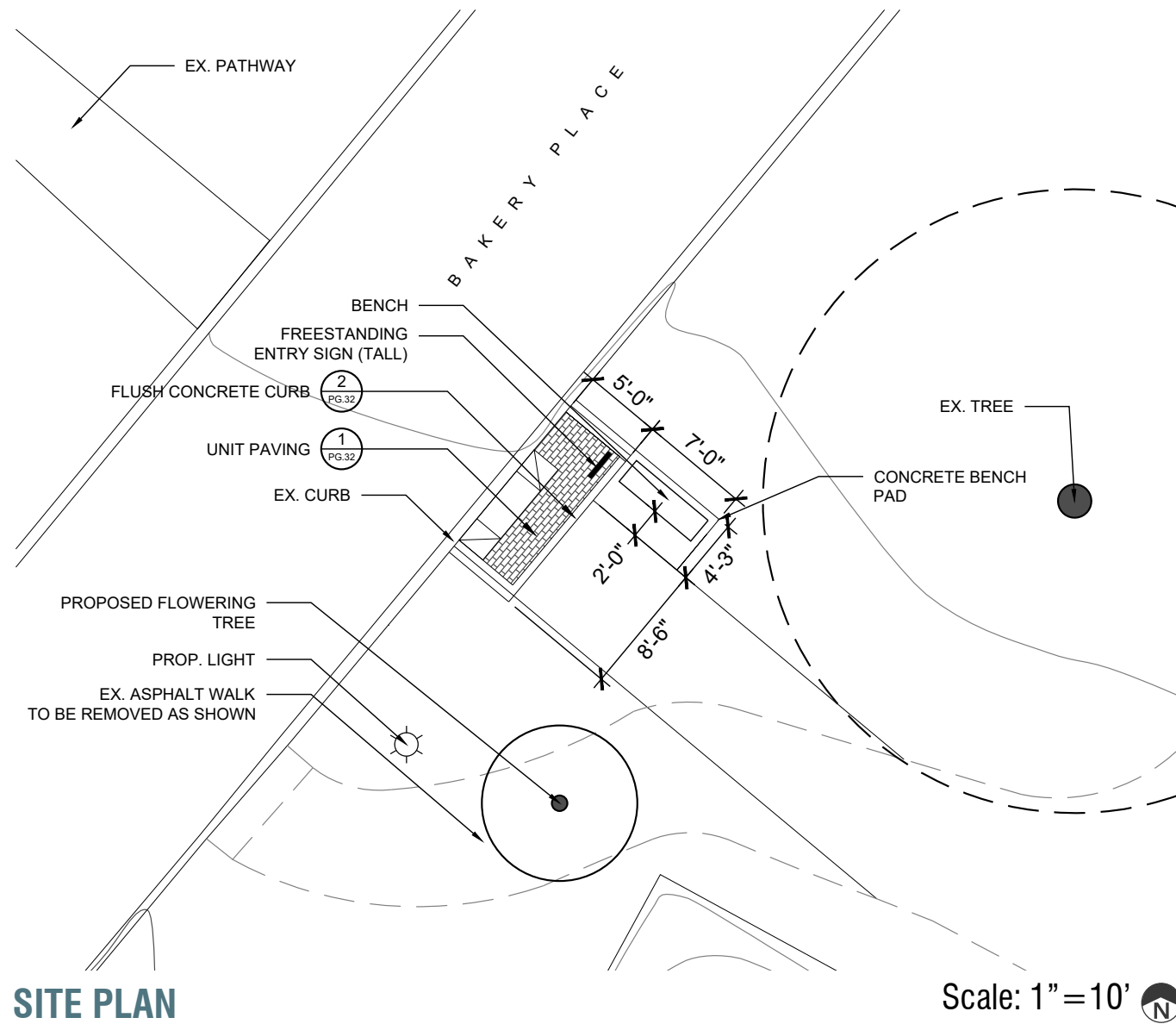

PERSPECTIVE ILLUSTRATION

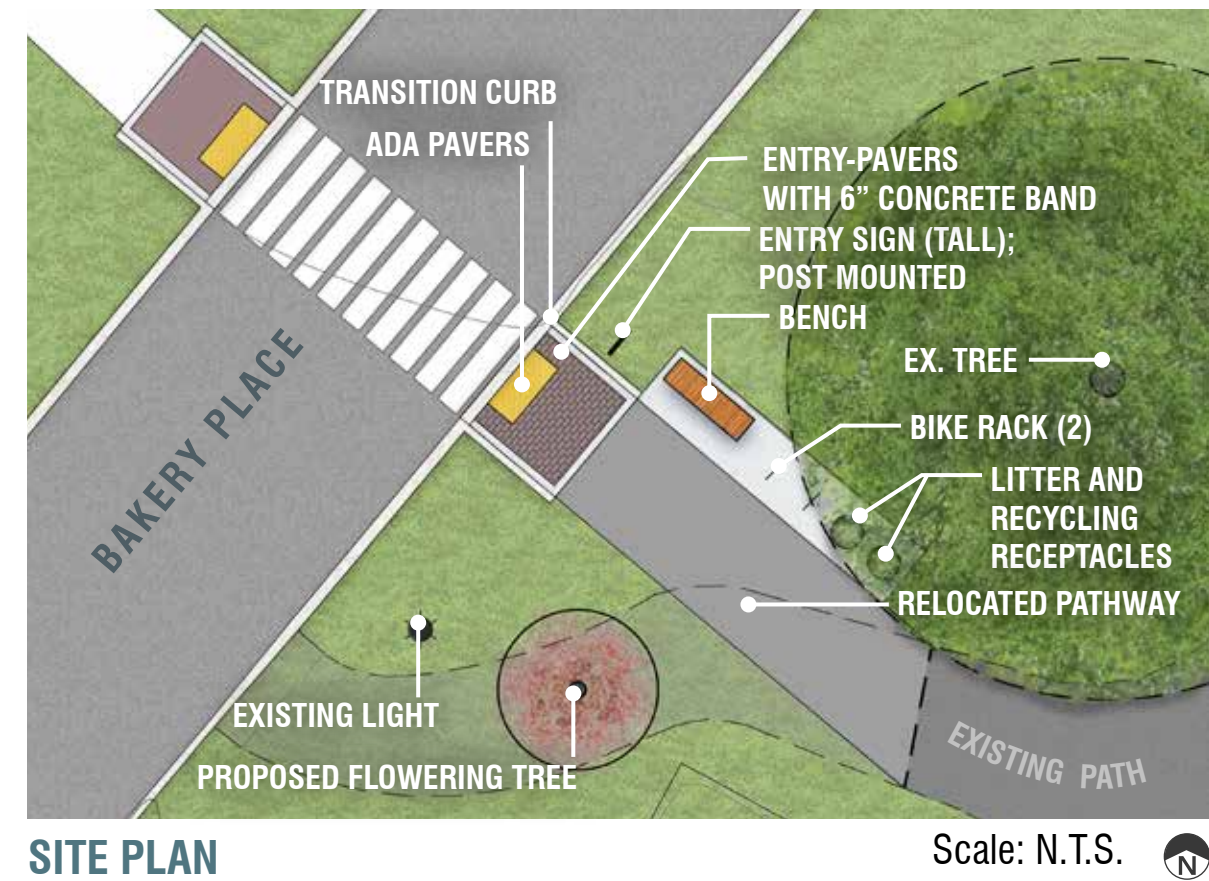

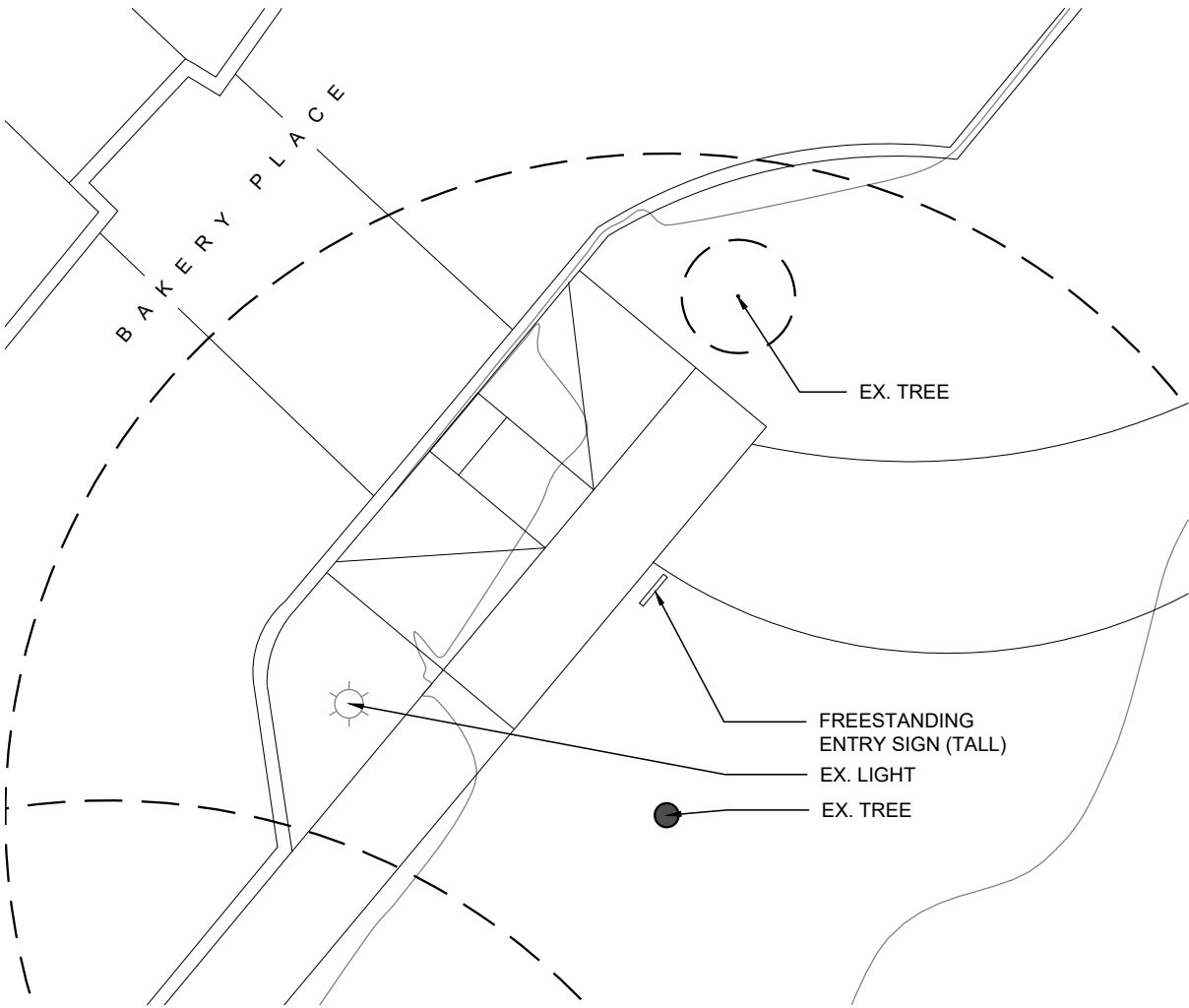
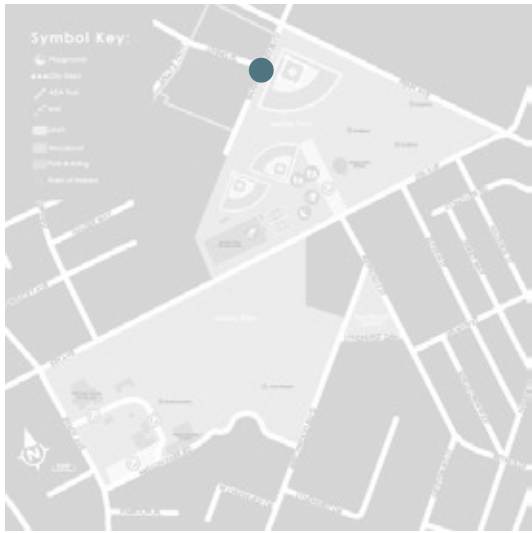

SITE PLAN

Scale: 1"=10' 



PERSPECTIVE ILLUSTRATION

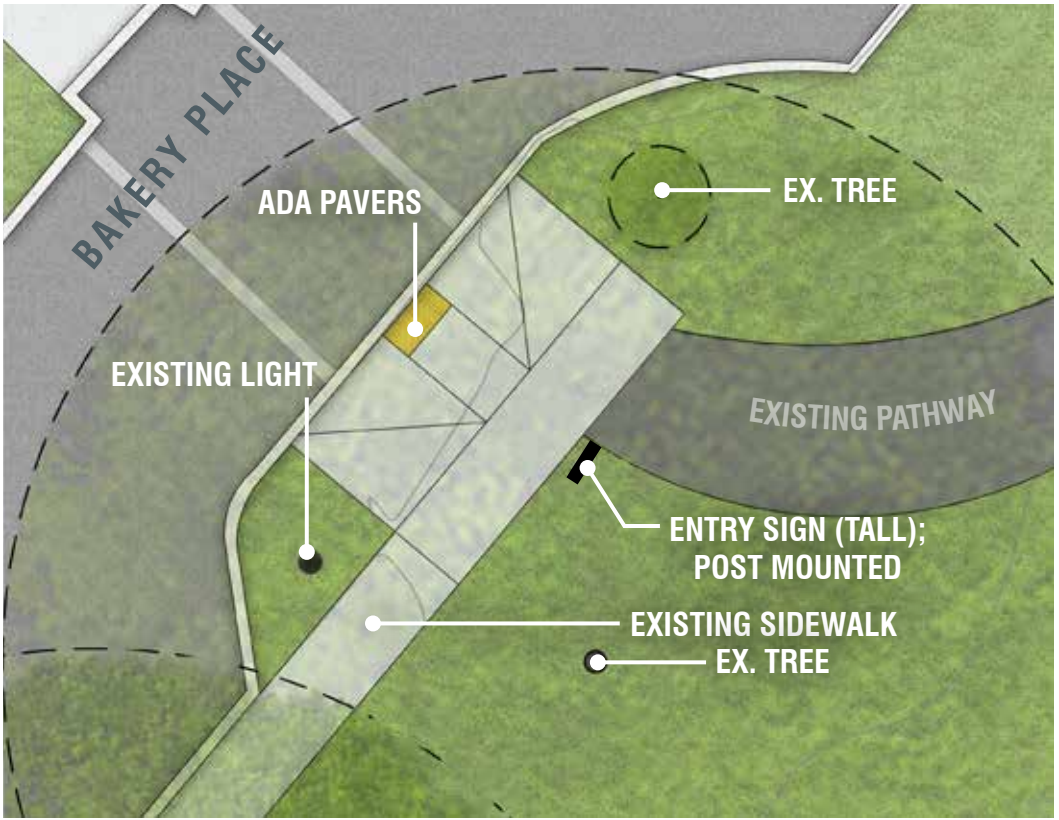

SITE PLAN

Scale: N.T.S. 

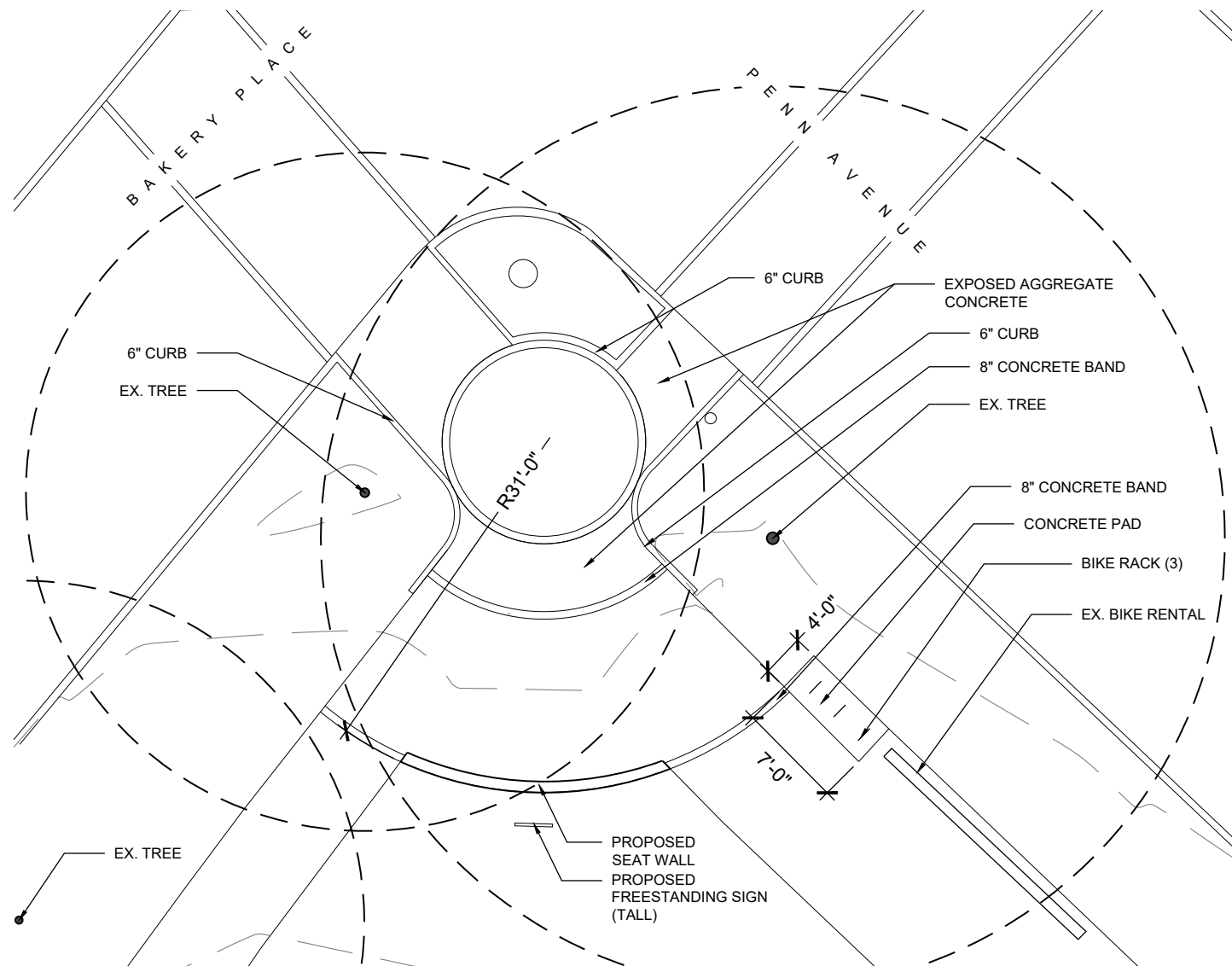
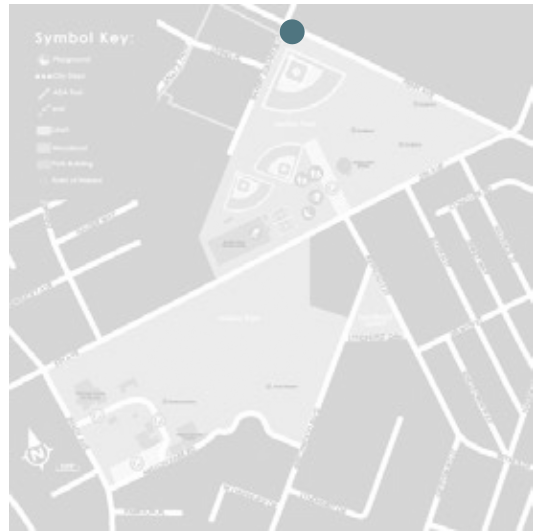

SITE PLAN

Scale: 1/8" = 1'-0"



EXISTING CONDITIONS



SITE PLAN

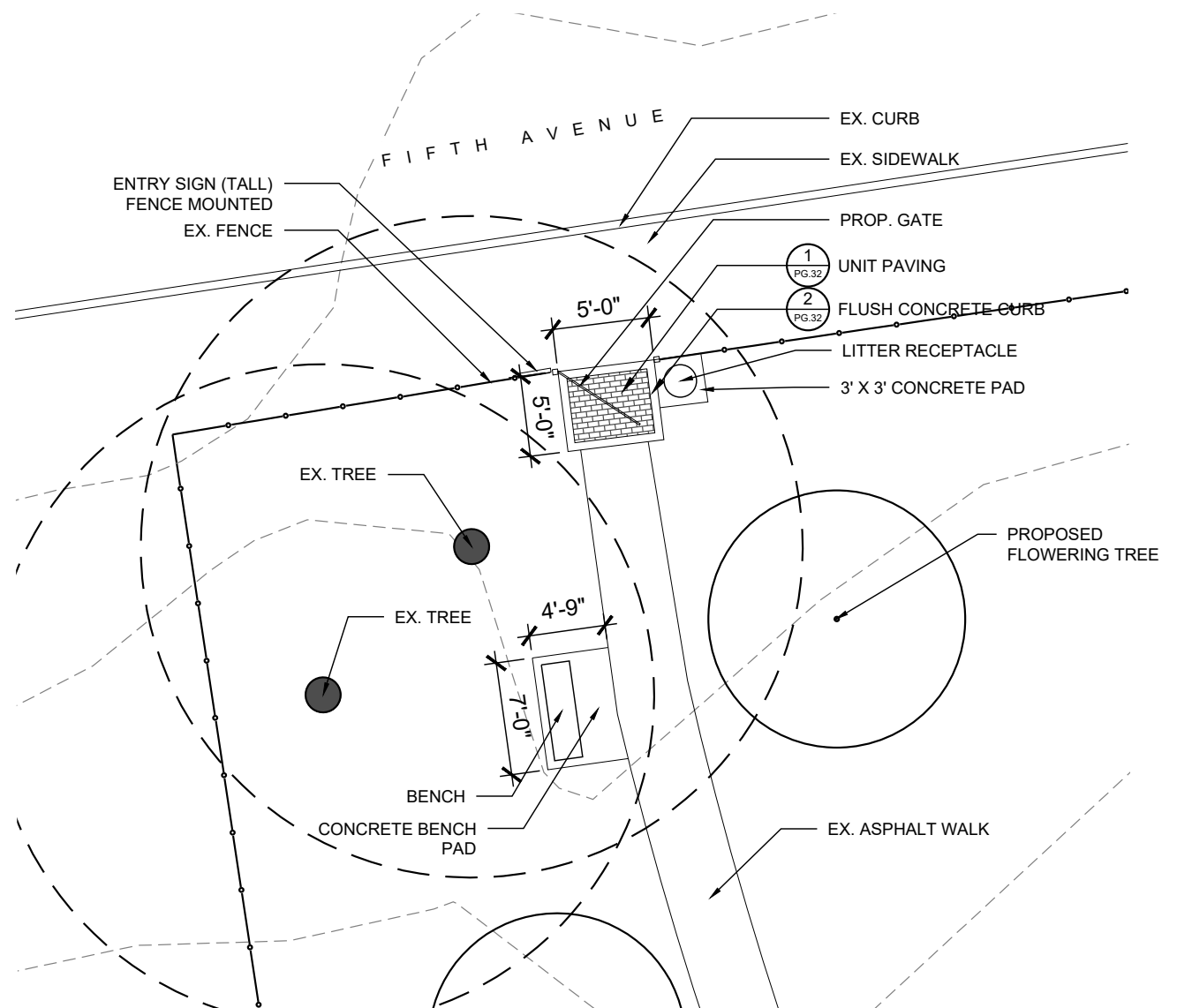

SITE PLAN*

Scale: 1"=10' 



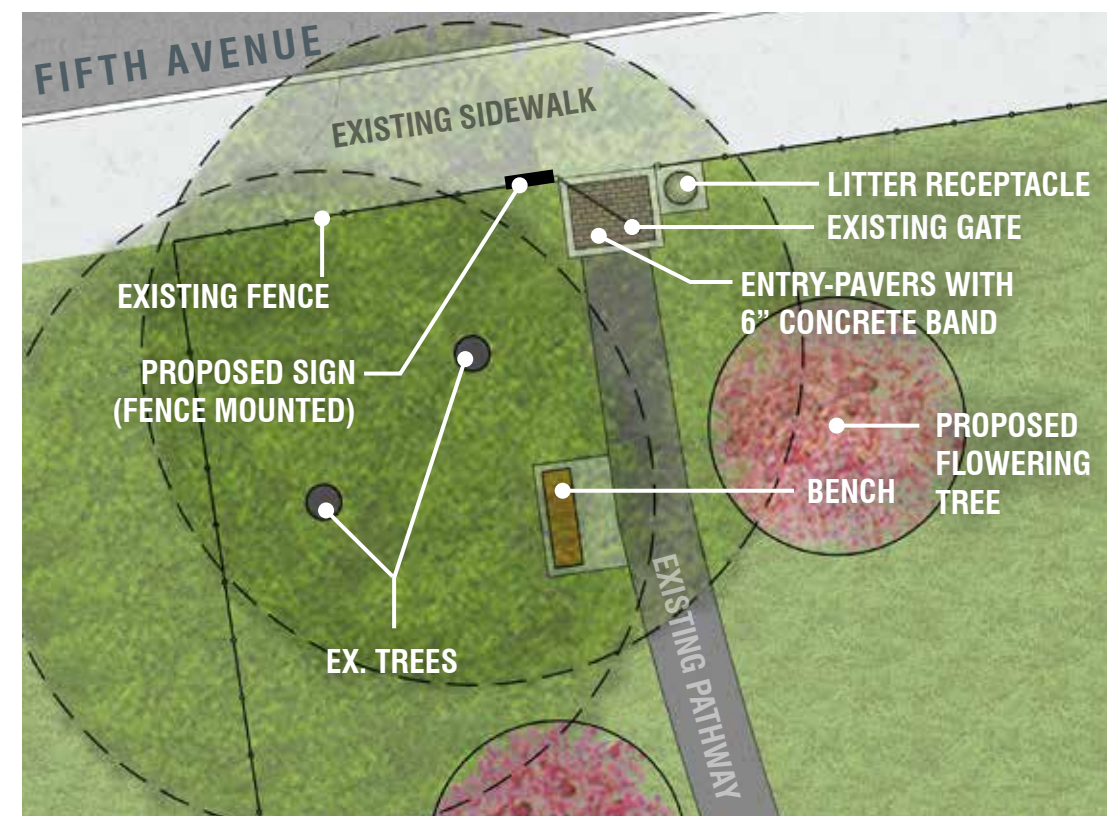

PERSPECTIVE ILLUSTRATION

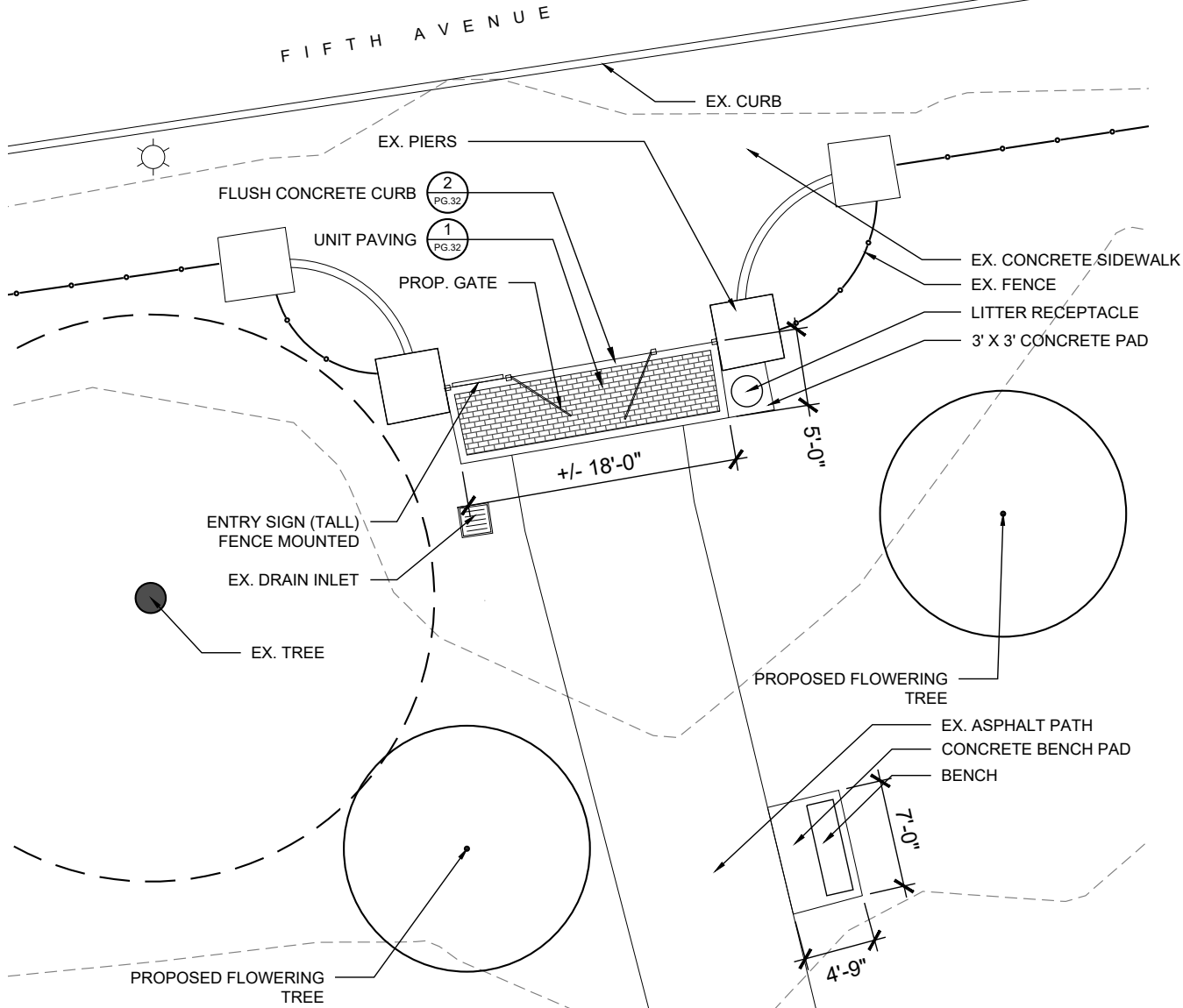

SITE PLAN

Scale: N.T.S. 



Scale: 1"=10' 

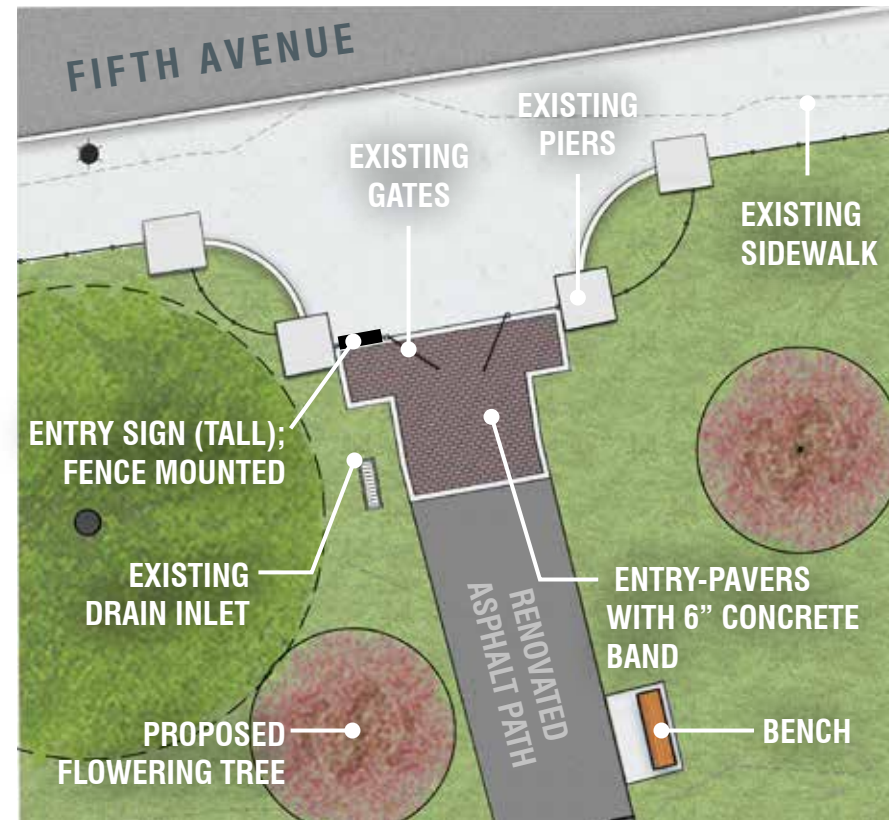

Scale: N.T.S. 

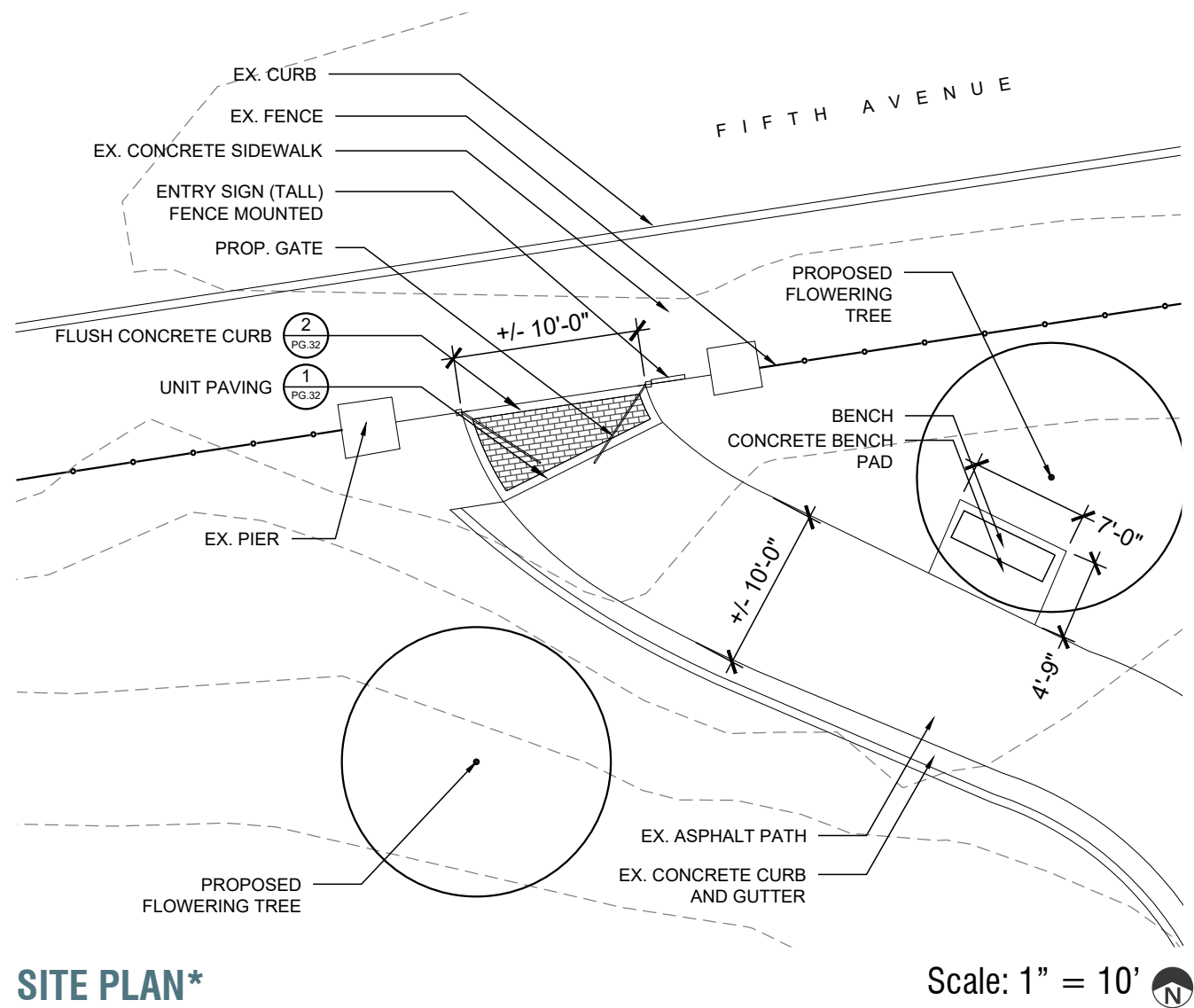
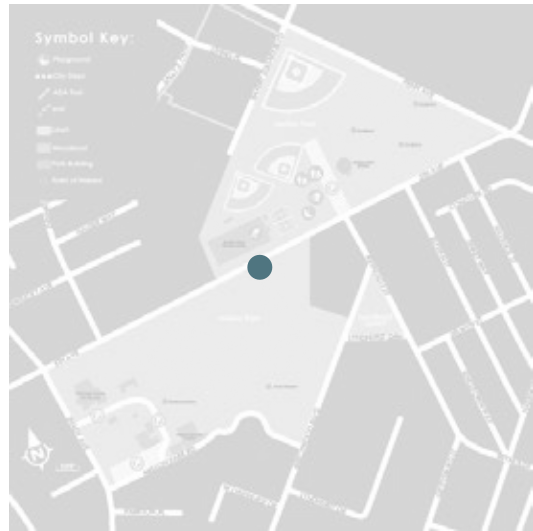

SITE PLAN*



PERSPECTIVE ILLUSTRATION

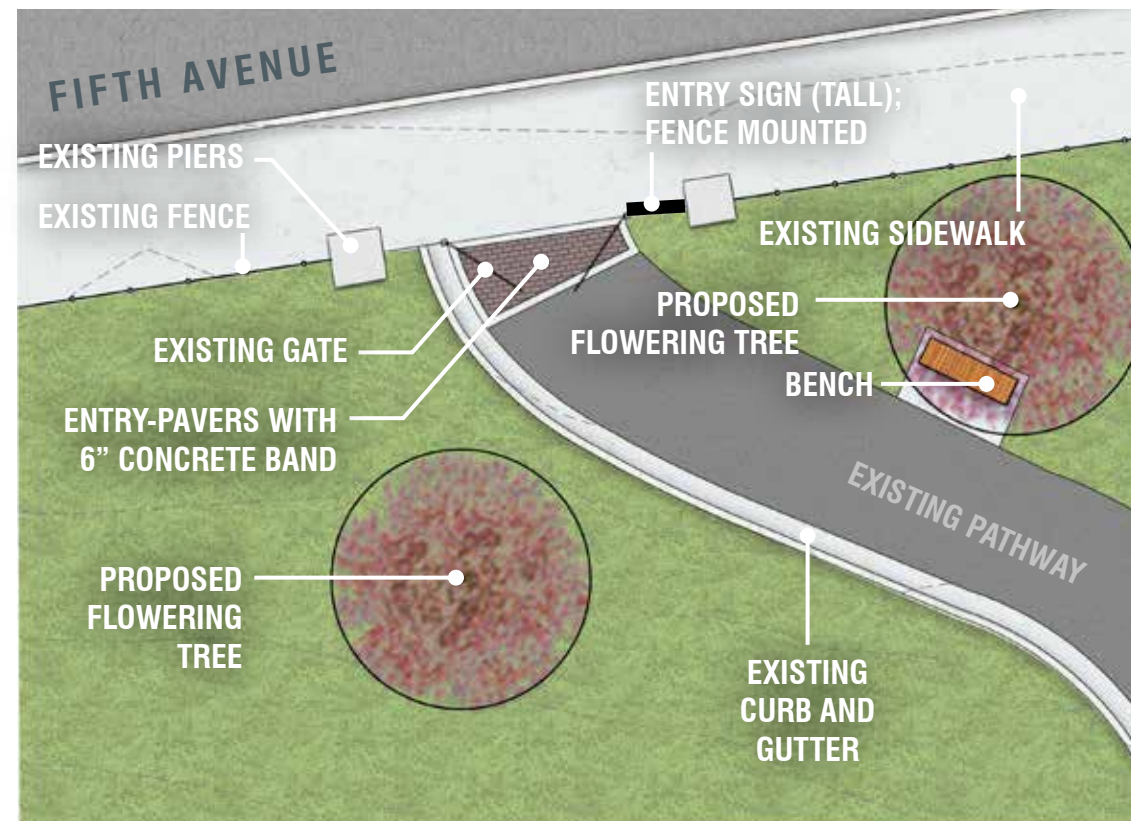

SITE PLAN

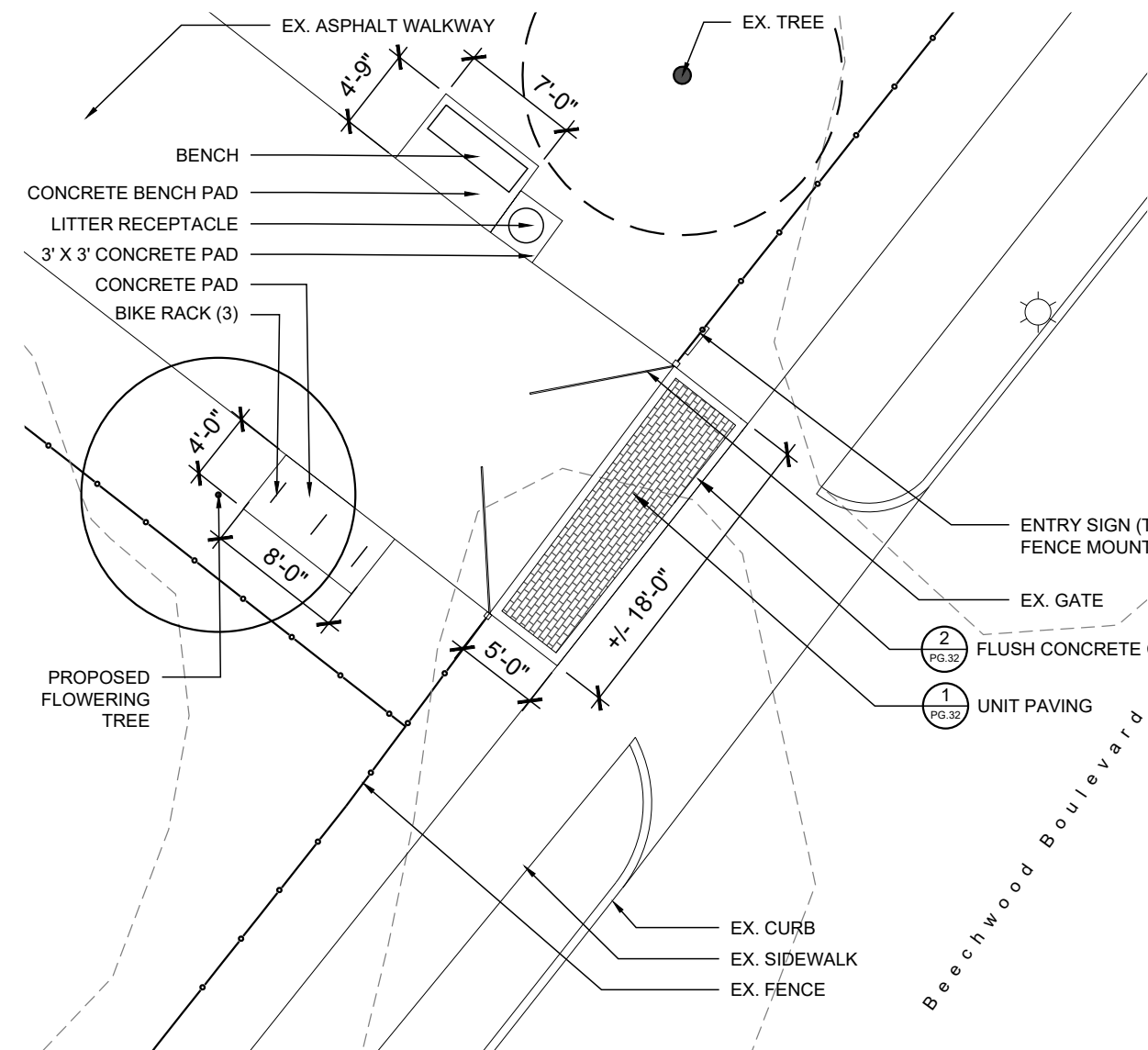
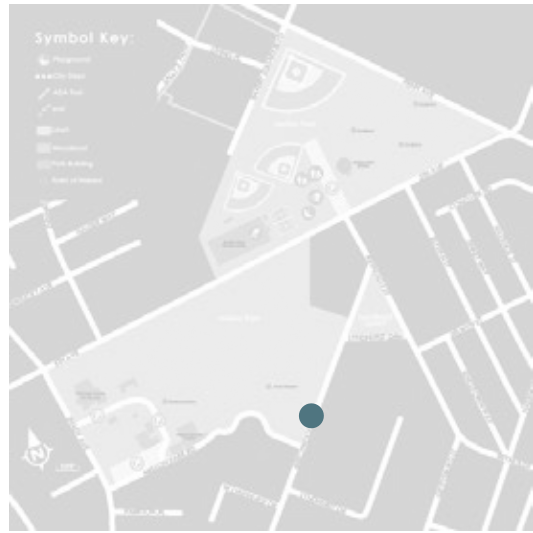

SITE PLAN*

Scale: 1" = 10'



PERSPECTIVE ILLUSTRATION

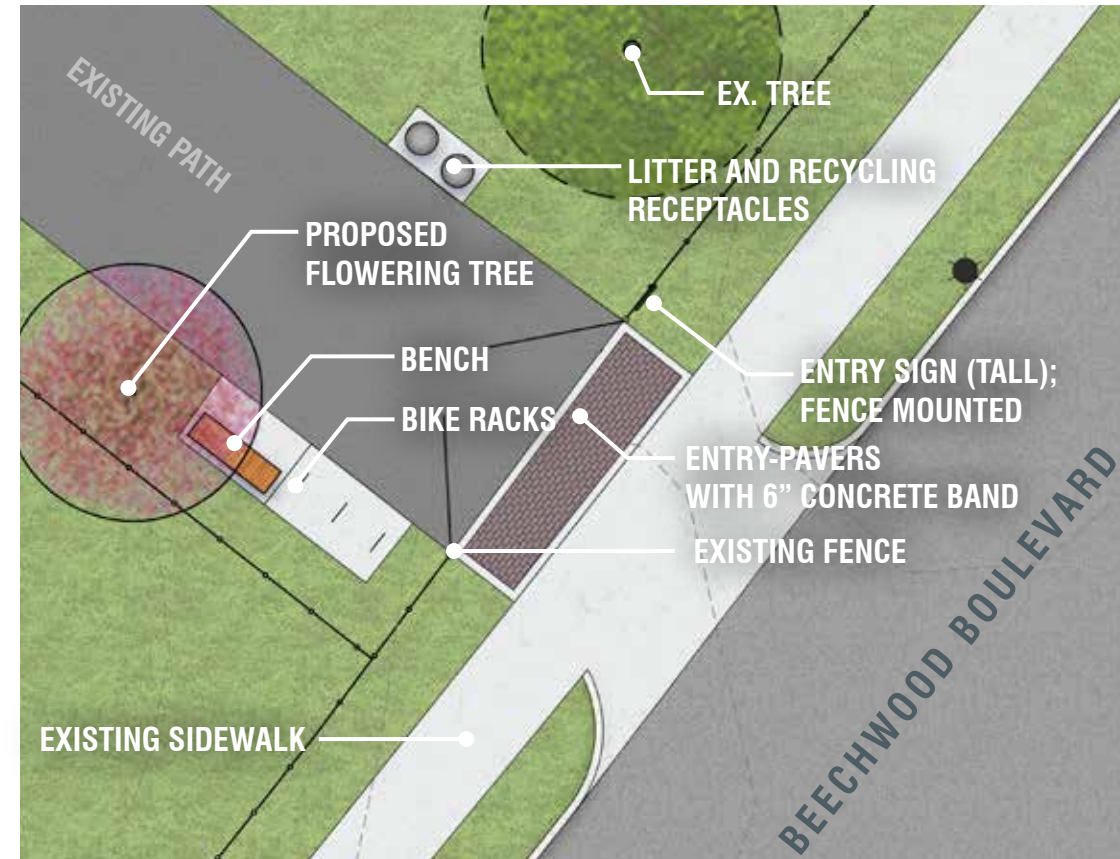

SITE PLAN

Scale: N.T.S.

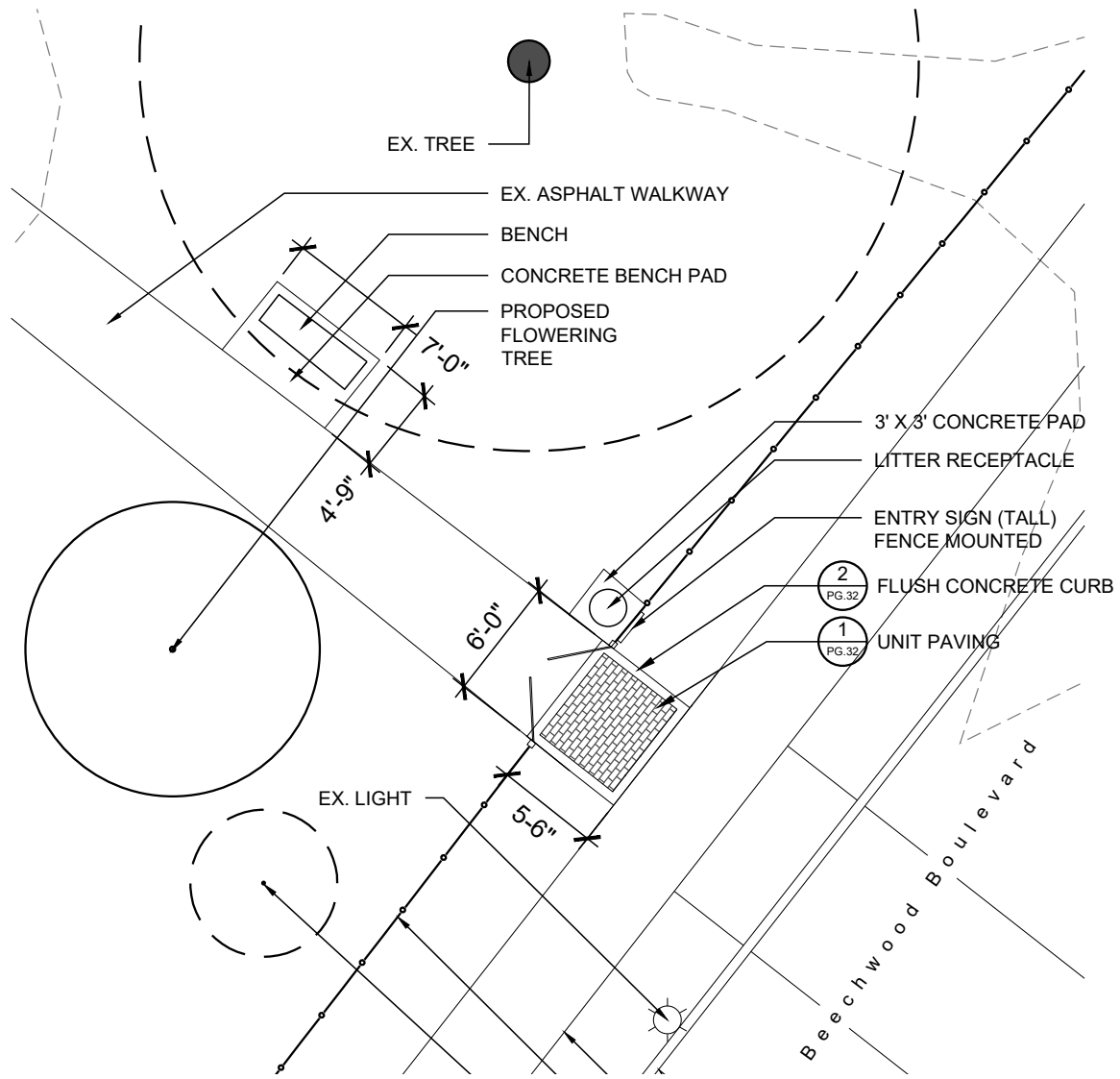
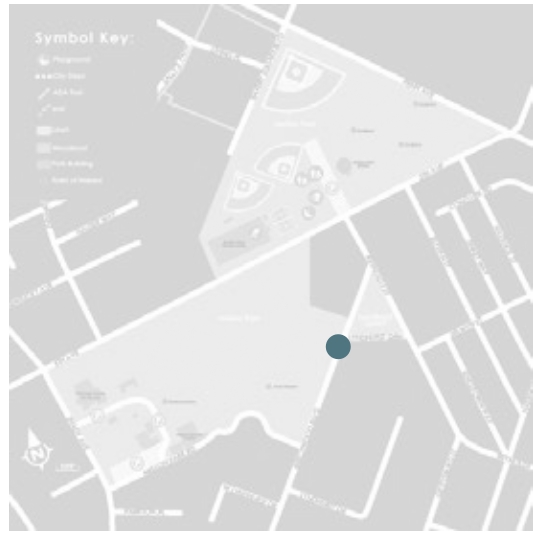

SITE PLAN*

Scale: 1" = 10'



PERSPECTIVE ILLUSTRATION

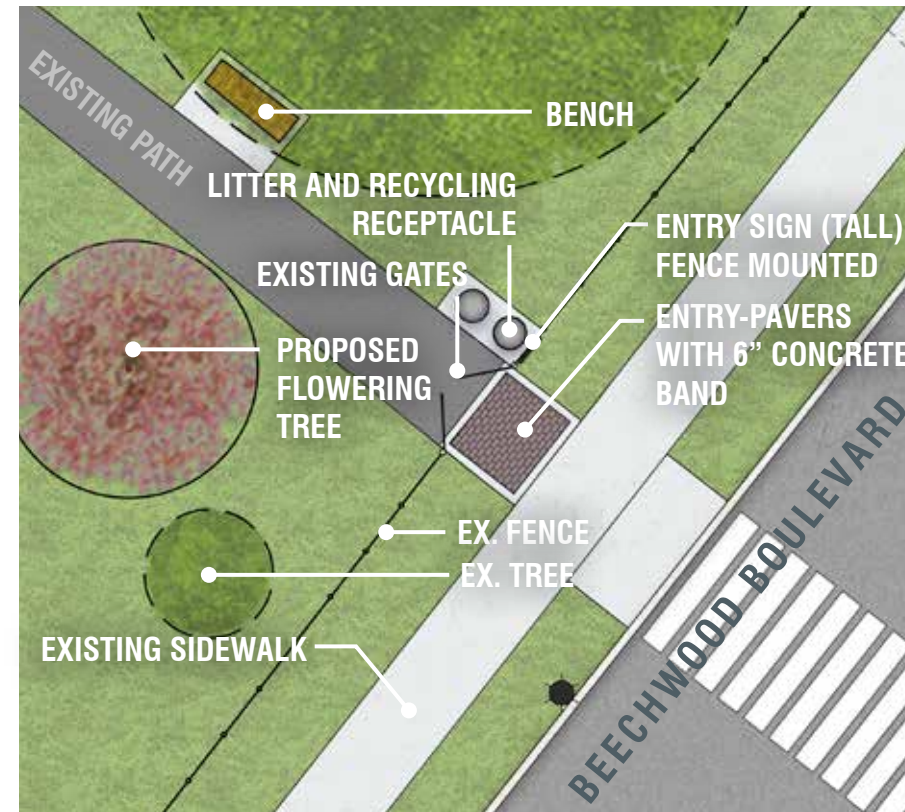

SITE PLAN

Scale: N.T.S.

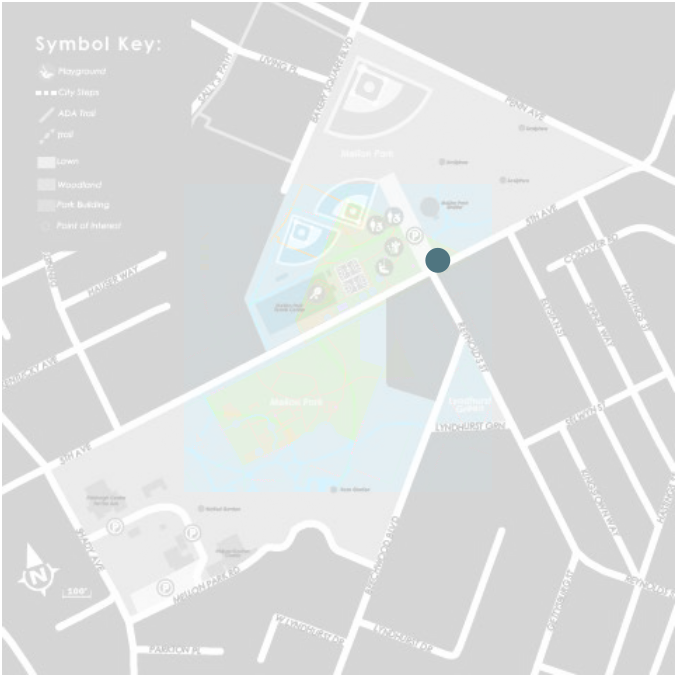

KEY MAP



CURRENT CONDITIONS

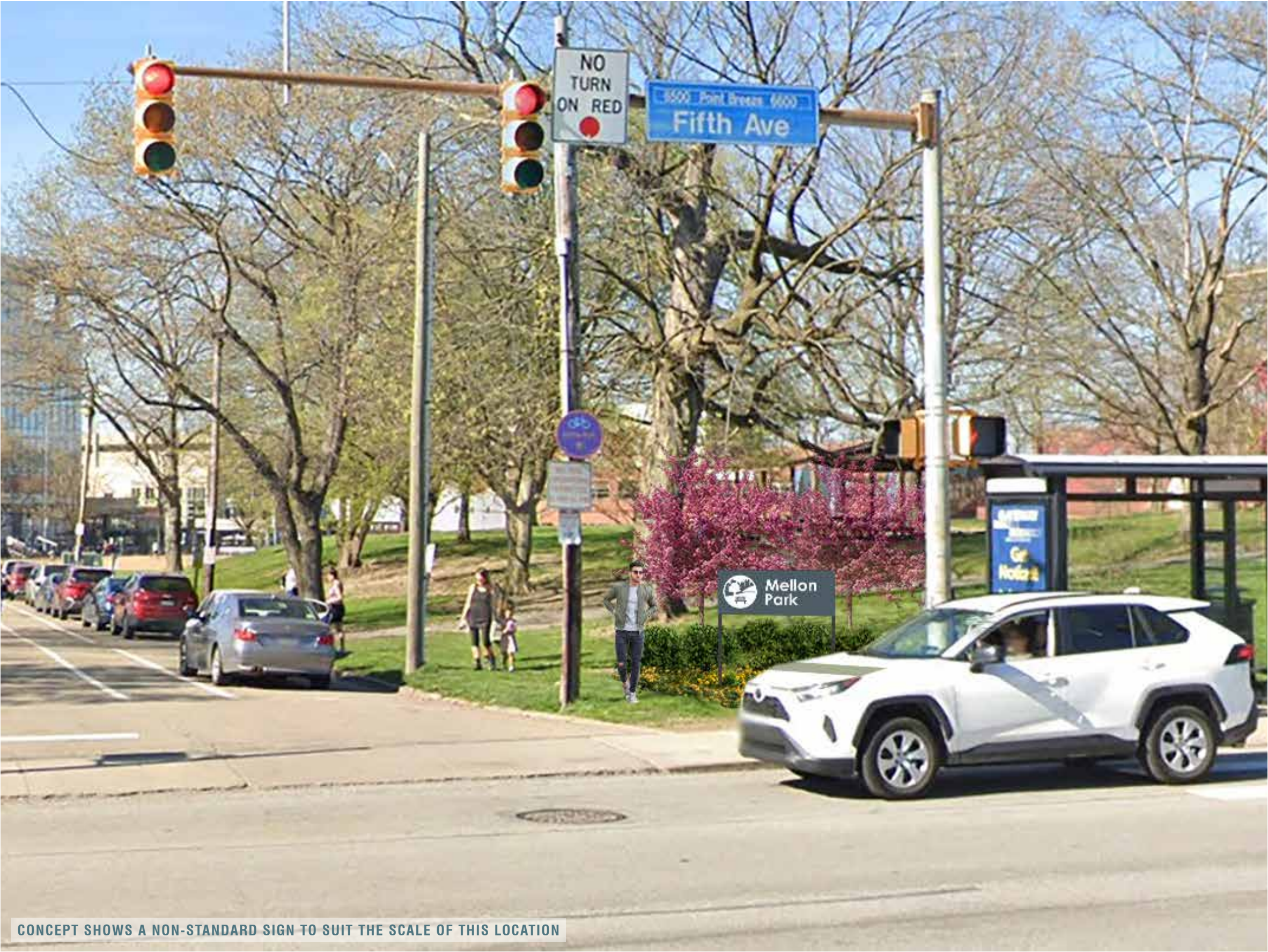

CONCEPT SHOWS A NON-STANDARD SIGN TO SUIT THE SCALE OF THIS LOCATION

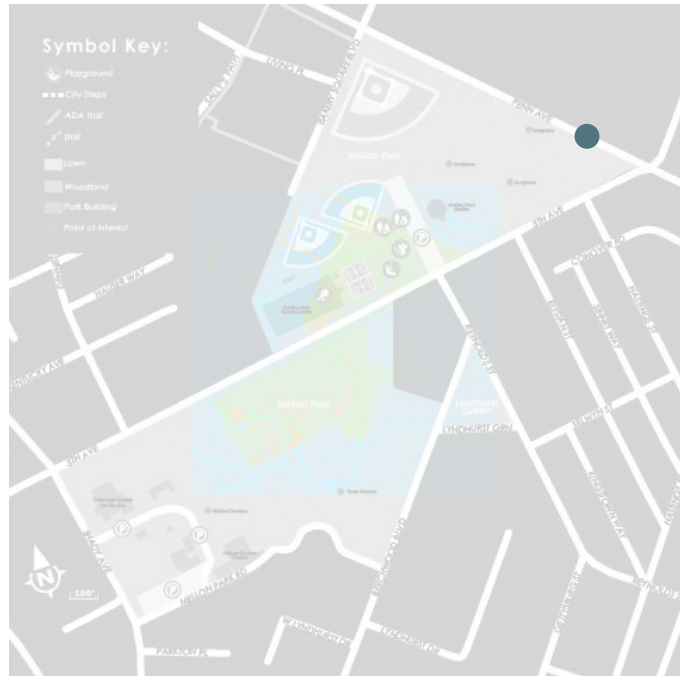

KEY MAP



CURRENT CONDITIONS



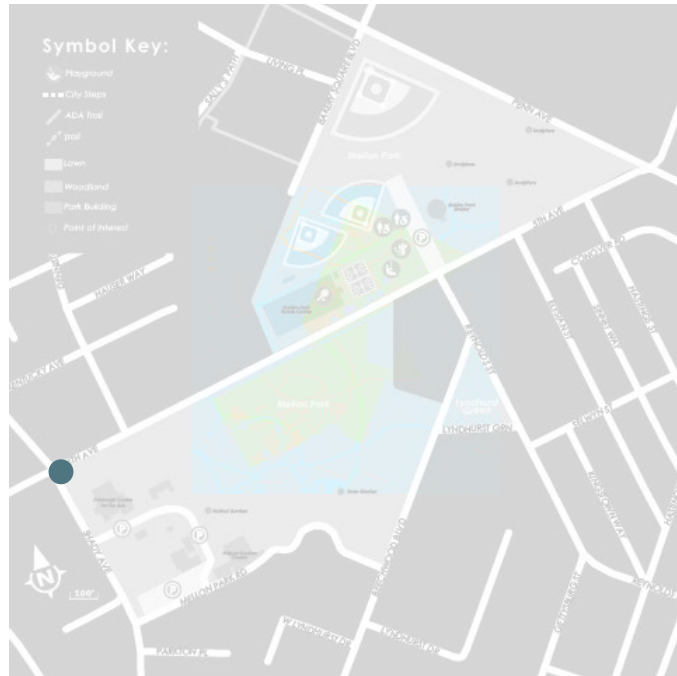

KEY MAP



CURRENT CONDITIONS





COMFORT STATION - NORTH MELLON PARK



WALLED GARDEN ENTRY - SOUTH MELLON PARK

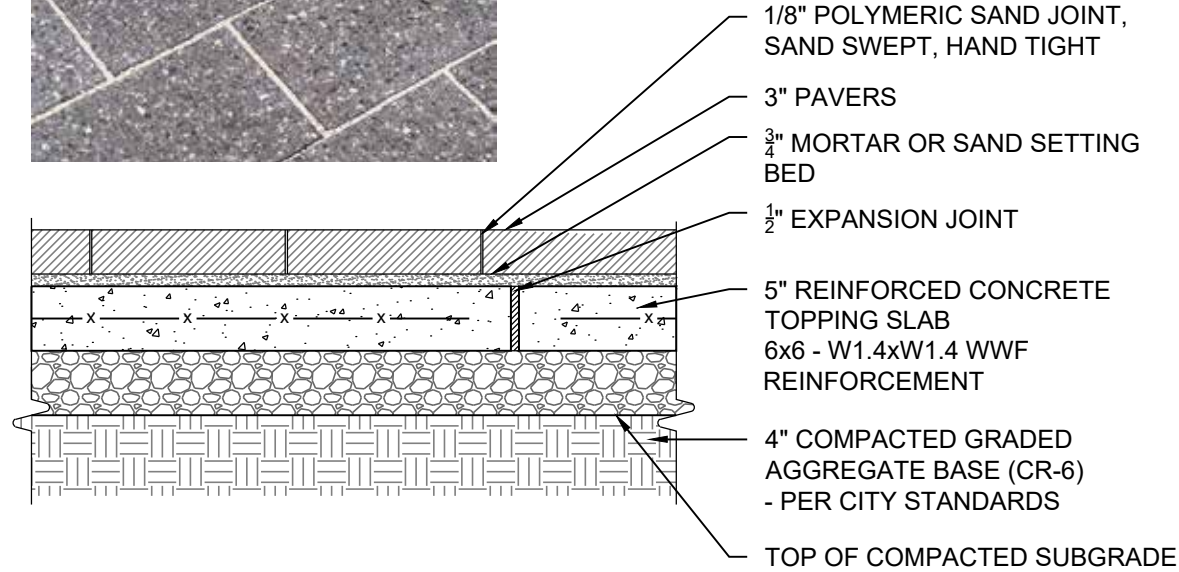

UNIT PAVING (ASPHALT) - OPTION A

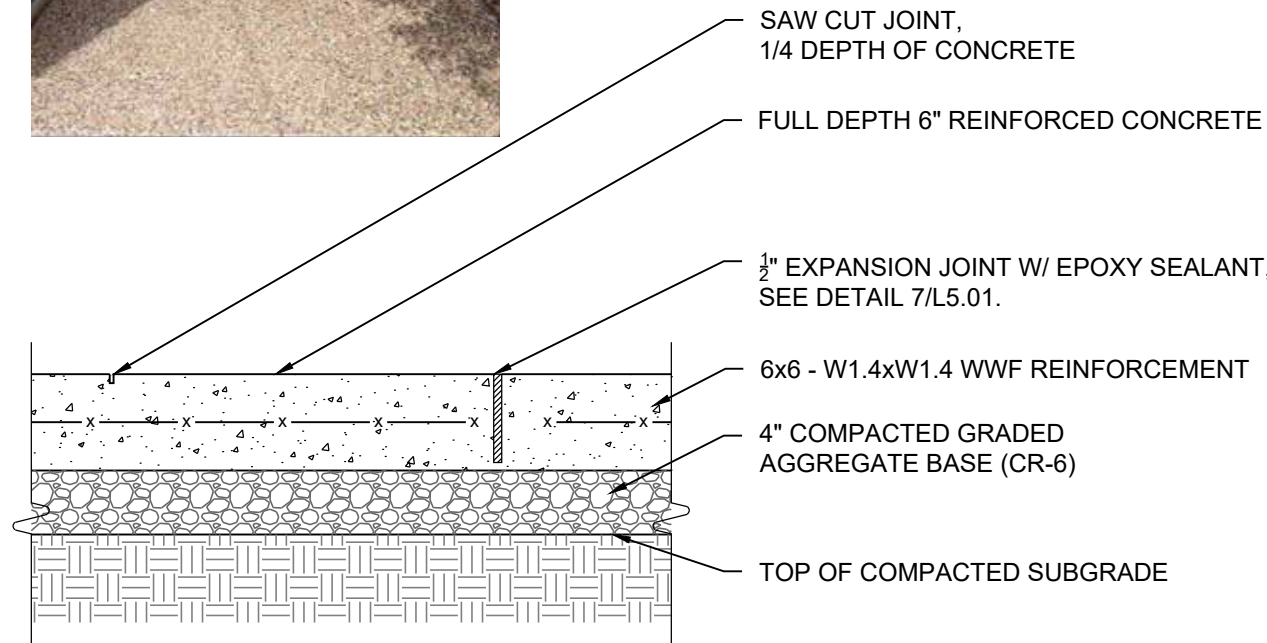

EXPOSED AGGREGATE CONCRETE - OPTION B

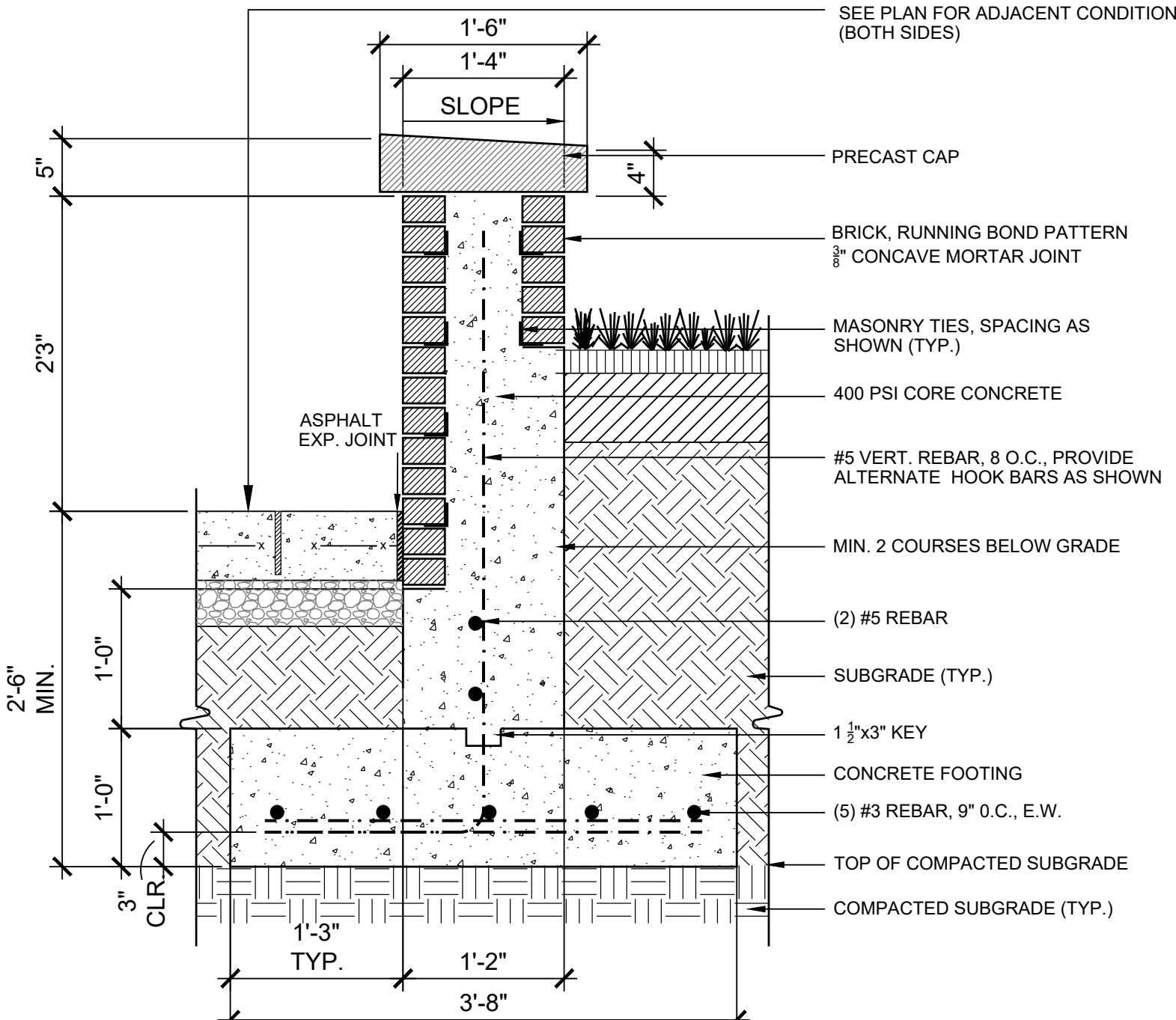

BRICK CLAD CONCRETE RETAINING WALL